

# PRINTRONIX®

## AUTO ID

---

### T600 Printer Administrator's Manual



---

*Thermal Printer*

## READ THIS SOFTWARE LICENSE AGREEMENT BEFORE USING THIS PRINTER

### Software License Agreement

CAREFULLY READ THE FOLLOWING TERMS AND CONDITIONS BEFORE USING THIS PRINTER. USING THIS PRINTER INDICATES YOUR ACCEPTANCE OF THESE TERMS AND CONDITIONS. IF YOU DO NOT AGREE TO THESE TERMS AND CONDITIONS, PROMPTLY RETURN THE PRINTER AND ALL ACCOMPANYING HARDWARE AND WRITTEN MATERIALS TO THE PLACE YOU OBTAINED THEM, AND YOUR MONEY WILL BE REFUNDED.

#### Definitions.

"Software" shall mean the digitally encoded, machine-readable data and program. The term "Software Product" includes the Software resident in the printer and its documentation. The Software Product is licensed (not sold) to you, and Printronix Auto ID Technology, Inc. either owns or licenses from other vendors who own, all copyright, trade secret, patent and other proprietary rights in the Software Product.

#### License.

1. Authorized Use. You agree to accept a non-exclusive license to use the Software resident in the printer solely for your own customary business or personal purposes.
2. Restrictions.
  - a. To protect the proprietary rights of Printronix Auto ID Technology, Inc., you agree to maintain the Software Product and other proprietary information concerning the typefaces in strict confidence.
  - b. You agree not to duplicate or copy the Software Product.
  - c. You shall not sublicense, sell, lease, or otherwise transfer all or any portion of the Software Product separate from the printer, without the prior written consent of Printronix Auto ID Technology, Inc.
  - d. You may not modify or prepare derivative works of the Software Product.
  - e. You may not transmit the Software Product over a network, by telephone, or electronically using any means; or reverse engineer, decompile or disassemble the Software.
  - f. You agree to keep confidential and use your best efforts to prevent and protect the contents of the Software Product from unauthorized disclosure or use.
3. Transfer. You may transfer the Software Product with the printer, but only if the recipient agrees to accept the terms and conditions of this Agreement. Your license is automatically terminated if you transfer the Software Product and printer.

#### Limited Software Product Warranty

Printronix Auto ID Technology, Inc. warrants that for ninety (90) days after delivery, the Software will perform in accordance with specifications published by Printronix Auto ID Technology, Inc. Printronix Auto ID Technology, Inc. does not warrant that the Software is free from all bugs, errors and omissions.

#### Remedy

Your exclusive remedy and the sole liability of Printronix Auto ID Technology, Inc. in connection with the Software is replacement of defective software with a copy of the same version and revision level.

#### Disclaimer of Warranties and Limitation of Remedies

1. THE PARTIES AGREE THAT ALL OTHER WARRANTIES, EXPRESS OR IMPLIED, INCLUDING WARRANTIES OF FITNESS FOR A PARTICULAR PURPOSE AND MERCHANTABILITY ARE EXCLUDED.  
Printronix Auto ID Technology, Inc. does not warrant that the functions contained in the Software will meet your requirements or that the operation of the Software will be uninterrupted or error free. Printronix Auto ID Technology, Inc. reserves the right to make changes and/or improvements in the Software without notice at any time.
2. IN NO EVENT WILL PRINTRONIX AUTO ID TECHNOLOGY, INC. BE LIABLE FOR LOST PROFITS, LOST DATA, BUSINESS INTERRUPTIONS, OR ANY OTHER DIRECT, INDIRECT, INCIDENTAL OR CONSEQUENTIAL DAMAGES ARISING OUT OF THE USE OF OR INABILITY TO USE THIS PRODUCT, EVEN IF PRINTRONIX AUTO ID TECHNOLOGY, INC. HAS BEEN ADVISED OF THE POSSIBILITY OF SUCH DAMAGES, OR ANY DAMAGES CAUSED BY THE ABUSE OR MANIPULATION OF THE SOFTWARE. SOME STATES DO NOT ALLOW THE EXCLUSION OR LIMITATION OF LIABILITY FOR CONSEQUENTIAL OR INCIDENTAL DAMAGES, SO THE ABOVE LIMITATION MAY NOT APPLY TO YOU.
3. Printronix Auto ID Technology, Inc. will not be liable for any loss or damage caused by delay in furnishing a Software Product or any other performance under this Agreement.
4. Our entire liability and your exclusive remedies for our liability of any kind (including liability for negligence except liability for personal injury caused solely by our negligence) for the Software Product covered by this Agreement and all other performance or nonperformance by us under or related to this Agreement are limited to the remedies specified by this Agreement.
5. California law governs this Agreement.

#### Termination of License Agreement

This License shall continue until terminated. This license may be terminated by agreement between you and Printronix Auto ID Technology, Inc. or by Printronix Auto ID Technology, Inc. If you fail to comply with the terms of this License and such failure is not corrected within thirty (30) days after notice. When this License is terminated, you shall return to the place you obtained them, the printer and all copies of the Software and documentation.

#### U.S. Government Restricted Rights

Use, duplication or disclosure by the Government is subject to restrictions as set forth in the Rights in Technical Data and Computer Software clause at FAR 242.227-7013, subdivision

1 (3) (ii) or subparagraph (c) (1) (ii), as appropriate.

Further use, duplication or disclosure is subject to restrictions applicable to restricted rights software as set forth in FAR 52.227-19 (c) (2).

#### Acknowledgement of Terms and Conditions

YOU ACKNOWLEDGE THAT YOU HAVE READ THIS AGREEMENT, UNDERSTAND IT, AND AGREE TO BE BOUND BY ITS TERMS AND CONDITIONS. NEITHER PARTY SHALL BE BOUND BY ANY STATEMENT OR REPRESENTATION NOT CONTAINED IN THIS AGREEMENT. NO CHANGE IN THIS AGREEMENT IS EFFECTIVE UNLESS WRITTEN AND SIGNED BY PROPERLY AUTHORIZED REPRESENTATIVES OF EACH PARTY. BY USING THIS PRINTER, YOU AGREE TO ACCEPT THE TERMS AND CONDITIONS OF THIS AGREEMENT.

## Trademark Acknowledgements

CSA is a registered certification mark of the Canadian Standards Association.

EIA is a registered service mark of the Electronic Industries Association.

IEEE is a registered service mark of the Institute of Electrical and Electronics Engineers, Inc.

TUV is a registered certification mark of TUV Rheinland of North America, Inc. UL is a registered certification mark of Underwriters Laboratories, Inc.

CG Triumvirate is a trademark of Agfa Corporation.

CG Triumvirate Bold Condensed font is under license from the Monotype Corporation.

Printronix and M4L are trademarks of Printronix Auto ID Technology, Inc.

ZPL and ZPL II are registered trademarks of Zebra Technologies Corporation.

Windows is a registered trademark of Microsoft Corporation.

All other trademarks are the property of their respective owners

## Notice of Copyright

This document contains proprietary information protected by copyright. No part of this document may be reproduced, copied, translated, or incorporated in any other material in any form or by any means, whether manual, graphic, electronic, mechanical, or otherwise, without the written consent of Printronix Auto ID Technology, Inc.

All non-Printronix registered and/or unregistered trademarks used throughout this manual are the sole property of their respective owners.

COPYRIGHT © 2016 PRINTRONIX AUTO ID TECHNOLOGY, INC. All rights reserved.

## Agency Compliance and Approvals



**EN 55032, Class B**  
**EN 55024**  
**EN 60950-1**  
**EN 61000-3-2**  
**EN 61000-3-3**



---

**FCC part 15B, Class B**  
**ICES-003, Class B**

This equipment has been tested and found to comply with the limits for a Class B digital device, pursuant to part 15 of the FCC Rules. These limits are designed to provide reasonable protection against harmful interference in a residential installation. This equipment generates, uses and can radiate radio frequency energy and, if not installed and used in accordance with the instructions, may cause harmful interference to radio communications. However, there is no guarantee that interference will not occur in a particular installation. If this equipment does cause harmful interference to radio or television reception, which can be determined by turning the equipment off and on, the user is encouraged to try to correct the interference by one or more of the following measures:

- Reorient or relocate the receiving antenna.
  - Increase the separation between the equipment and receiver.
-

- 
- Connect the equipment into an outlet on a circuit different from that to which the receiver is connected.
  - Consult the dealer or an experienced radio/ TV technician for help.

This device complies with Part 15 of the FCC Rules. Operation is subject to the following two conditions: (1) This device may cause harmful interference, and (2) this device must accept any interference received, including interference that may cause undesired operation.

**This Class B digital apparatus complies with Canadian ICES-003.**

Cet appareil numérique de la classe B est conforme à la norme NMB-003 du Canada.

---



**AS/NZS CISPR 32, Class B**

---



**UL 60950-1(2nd Edition)  
CSA C22.2 No. 60950-1-07(2nd Edition)**

---



**Energy Star for Imaging Equipment Version 2.0**

---

**Important safety instructions:**

1. Read all of these instructions and keep them for later use.
2. Follow all warnings and instructions on the product.
3. Disconnect the power plug from the AC outlet before cleaning or if fault happened. Do not use liquid or aerosol cleaners. Using a damp cloth is suitable for cleaning.
4. The mains socket shall be installed near the equipment and easily accessible.
5. The unit must be protected against moisture.
6. Ensure the stability when installing the device, Tipping or dropping could cause damage.
7. Make sure to follow the correct power rating and power type indicated on marking label provided by manufacture.
8. Please refer to user manual for maximum operation ambient temperature.

**WARNING:**

Hazardous moving parts, keep fingers and other body parts away.

**CAUTION:**

(For equipment with RTC (CR2032) battery or rechargeable battery pack)

Risk of explosion if battery is replaced by an incorrect type.

Dispose of used batteries according to the Instructions as below.

1. DO NOT throw the battery in fire.
2. DO NOT short circuit the contacts.
3. DO NOT disassemble the battery.
4. DO NOT throw the battery in municipal waste.
5. The symbol of the crossed out wheeled bin indicates that the battery should not be placed in municipal waste.



**Caution:** The printhead may be hot and could cause severe burns. Allow the printhead to cool.

**Note :**

- \* **Continuous printing will cause the printer motor to overheat. The printer will stop printing automatically for about 10~15 minutes while the motor is cooling down. Do not turn the power off when the printer pauses or the data transferred to the printer buffer will be lost.**
  
- \* **The maximum printing ratio per dot line is 15% for this printer. To print the full web black line, the maximum black line height is limited to 40 dots, which is 5mm for 203 DPI resolution printer and 3.3mm for 300 DPI resolution printers only, otherwise this may damage the power supply.**

# Contents

- 1. Introduction ..... 1
  - 1.1 Product Introduction ..... 1
  - 1.2 Product Features ..... 2
    - 1.2.1 Printer Standard Features** ..... 2
    - 1.2.2 Printer Optional Features** ..... 3
  - 1.3 General Specifications ..... 3
  - 1.4 Print Specifications ..... 4
  - 1.5 Ribbon Specifications ..... 4
  - 1.6 Media Specifications ..... 5
- 2. Operations Overview ..... 6
  - 2.1 Unpacking and Inspection ..... 6
  - 2.2 Printer Overview ..... 7
    - 2.2.1 Front View** ..... 7
    - 2.2.2 Interior view** ..... 8
    - 2.2.3 Rear View** ..... 9
  - 2.3 Operator Control ..... 10
    - 2.3.1 LED Indication** ..... 10
    - 2.3.2 Button Function** ..... 10
- 3. Setup ..... 11
  - 3.1 Setting up the printer ..... 11
  - 3.2 Open/Close the Top Cover ..... 12
  - 3.3 Loading the Ribbon ..... 13
  - 3.4 Loading the Media ..... 16
    - 3.4.1 Loading the Media** ..... 16
    - 3.4.2 External Label Roll Mount Installation (Option)** ..... 19
    - 3.4.3 Loading Media in Peel-off Mode (Option)** ..... 21
    - 3.4.4 Loading Media in Cutter Mode (Option)** ..... 23
- 4. Configuration Utility ..... 24
  - 4.1 Start the Configuration Utility ..... 24
  - 4.2 Printer Function Button ..... 25
  - 4.3 Setting Ethernet by Configuration Utility ..... 26
- 5. Power-on Utilities ..... 28

5.1 Ribbon and Gap/Black Mark Sensor Calibration.....	29
5.2 Gap/Black Mark Calibration, Self-test and Dump Mode .....	30
5.3 Printer Initialization .....	34
5.4 Set Black Mark Sensor as Media Sensor and Calibrate the Black Mark Sensor.....	35
5.5 Set Gap Sensor as Media Sensor and Calibrate the Gap Sensor .....	36
5.6 Skip AUTO.BAS .....	37
6. LCD Menu Function .....	38
6.1 Enter the Menu .....	38
6.2 Main Menu Overview.....	39
6.3 TSPL.....	40
6.4 ZPL2 .....	42
6.5 Sensor.....	45
6.6 Interface.....	46
<b>6.6.1 Serial Comm.</b> .....	46
<b>6.6.2 Ethernet</b> .....	47
6.7 File Manager.....	48
6.8 Diagnostics .....	49
<b>6.8.1 Print Config</b> .....	49
<b>6.8.2 Dump Mode</b> .....	51
<b>6.8.3 Print Head</b> .....	52
<b>6.8.4 Display</b> .....	52
<b>6.8.5 Sensor</b> .....	52
6.9 Advanced.....	53
6.10 Service .....	54
7. Troubleshooting.....	55
8. Maintenance.....	58
Revise History .....	60





# 1. Introduction

---

## 1.1 Product Introduction

Thank you very much for purchasing this bar code printer.

This series of thermal transfer desktop barcode printer, label printer with its new, smaller footprint, offers the high performance that customers have come to expect. Durable, reliable and fast, this series generates 4-inch-wide labels, tags or receipts at up to 6 ips, offering a price-performance combination that is unmatched by other desktop thermal barcode printers on the market.

Support TPLE (Translation Printer Language Eltron®) and TPLZ (Translation Printer Language Zebra®).

The languages automatically decipher and translate the format of each label as it is sent to the printer.

TSPL-EZ also features internal scalable True Type fonts (based on the Monotype® font engine), which are typically found only in more expensive printers.

Applications:

- Point-of-sale
- Product marking
- Receipt/ coupon printing
- Compliance labeling
- Asset tracking
- Document management
- Shipping/ receiving
- Inventory control
- Specimen labeling
- Patient tracking

## 1.2 Product Features

### 1.2.1 Printer Standard Features

The printer offers the following standard features.

Product standard feature		
Thermal transfer/ or direct thermal		
6 operating buttons and 1 LED with 3 colors		
2.3" color TFT display, 320 x 240 pixel (UI of operating menu)		
32-bit RISC high performance processor (Atmel 9G25/ 400 MHz)		
Center alignment holder with spiral spring		
Gap transmissive sensor (Fixed, center of offset 4 from center)		
Black mark reflective sensor (Position adjustable)		
Ribbon encoder sensor		
Head open sensor		
Automatic media/ribbon sensor selecting		
128 MB Flash memory		
64 MB DDR2 DRAM		
SD card reader for memory expansion, up to 32 GB		
RS-232 interface (Max. 115,200 bps)		
USB 2.0 interface (Hi speed mode)		
Internal Ethernet print server (10/100 Mbps) interface		
USB host		
Standard industry emulations right out of the box including Eltron® and Zebra® language support		
Internal 8 alpha-numeric bitmap fonts		
Fonts and bar codes can be printed in any one of the four directions (0, 90,180, 270 degree)		
Internal Monotype Imaging® true type font engine with one CG Triumvirate Bold Condensed scalable font		
Downloadable fonts from PC to printer memory		
Bar code, graphics/image printing		
<b>Supported bar code</b>		<b>Supported image</b>
1D bar code	2D bar code	BITMAP, BMP, PCX (Max. 256 colors graphics)
Code128 subsets A.B.C, Code128UCC, EAN128, Interleave 2 of 5, Code 39, Code 93, EAN-13, EAN-8, Codabar, POSTNET, UPC-A, UPC-E, EAN and UPC 2(5) digits, MSI, PLESSEY, China Post, ITF14, EAN14, Code 11, TELPEN, PLANET, Code 49, Deutsche Post Identcode, Deutsche Post Leitcode, LOGMARS	CODABLOCK F mode, DataMatrix, Maxicode, PDF-417, Aztec, MicroPDF417, QR code, RSS Barcode (GS1 Databar)	

Supported code page:	<ul style="list-style-type: none"> <li>• Codepage 437 (English - US)</li> <li>• Codepage 737 (Greek)</li> <li>• Codepage 850 (Latin-1)</li> <li>• Codepage 852 (Latin-2)</li> <li>• Codepage 855 (Cyrillic)</li> <li>• Codepage 857 (Turkish)</li> <li>• Codepage 860 (Portuguese)</li> <li>• Codepage 861 (Icelandic)</li> <li>• Codepage 862 (Hebrew)</li> <li>• Codepage 863 (French Canadian)</li> <li>• Codepage 864 (Arabic)</li> <li>• Codepage 865 (Nordic)</li> <li>• Codepage 866 (Russian)</li> <li>• Codepage 869 (Greek 2)</li> <li>• Codepage 950 (Traditional Chinese)</li> <li>• Codepage 936 (Simplified Chinese)</li> <li>• Codepage 932 (Japanese)</li> <li>• Codepage 949 (Korean)</li> <li>• Codepage 1250 (Latin-2)</li> </ul>
	<ul style="list-style-type: none"> <li>• Codepage 1251 (Cyrillic)</li> <li>• Codepage 1252 (Latin-1)</li> <li>• Codepage 1253 (Greek)</li> <li>• Codepage 1254 (Turkish)</li> <li>• Codepage 1255 (Hebrew)</li> <li>• Codepage 1256 (Arabic)</li> <li>• Codepage 1257 (Baltic)</li> <li>• Codepage 1258 (Vietnam)</li> <li>• ISO-8859-1: Latin-1 (Western European)</li> <li>• ISO-8859-2: Latin-2 (Central European)</li> <li>• ISO-8859-3: Latin-3 (South European)</li> <li>• ISO-8859-4: Latin-4 (North European)</li> <li>• ISO-8859-5: Cyrillic</li> <li>• ISO-8859-6: Arabic</li> <li>• ISO-8859-7: Greek</li> <li>• ISO-8859-8: Hebrew</li> <li>• ISO-8859-9: Turkish</li> <li>• ISO-8859-10: Nordic</li> <li>• ISO-8859-15: Latin-9</li> <li>• UTF-8</li> </ul>

### 1.2.2 Printer Optional Features

The printer offers the following optional features.

Product option feature	User option	Dealer option	Factory option
Peel-off kit  <i>Paper length: 1" ~ 6"</i>  <i>Note:</i> <i>This peel-off module is supported for the thermal/ plain label only.</i>		○	
Regular cutter (full cut guillotine cutter)  <i>Paper thickness: 0.06~ 0.19 mm</i> <i>Paper length: 1" ~ max. length</i> <i>Max. width: 110 mm</i>  <i>Note:</i> <i>Except for the linerless cutter, all regular/heavy duty/care label cutters DO NOT cut on media with glue.</i>		○	
External roll mount with 3" core label spindle	○		

### 1.3 General Specifications

General Specifications	
<b>Physical dimensions</b>	203 mm(W) x 191.5 mm(H) x 259.3 mm(D)
<b>Weight</b>	2.3 kg (5.07 lbs)
<b>Mechanism</b>	Clamshell with Double-walled plastic
<b>Power</b>	External universal switching power supply

	<ul style="list-style-type: none"> <li>• Input: AC 100-240V/ 2.5A, 50-60 Hz</li> <li>• Output: DC 24V/ 3.75A, 90W</li> </ul>
<b>Environmental condition</b>	Operation: 5 ~ 40 °C (41 ~ 104 °F), 25~85% non-condensing Storage: -40 ~ 60 °C (-40 ~ 140 °F), 10~90% non-condensing
<b>Environmental concern</b>	Comply with RoHS, WEEE, REACH

## 1.4 Print Specifications

<b>Print Specifications</b>	<b>T620</b>	<b>T630</b>
<b>Print head resolution (dots per inch/mm)</b>	203 dots/inch (8 dots/mm)	300 dots/inch (12 dots/mm)
<b>Printing method</b>	Thermal transfer/ or direct thermal	
<b>Dot size (width x length)</b>	0.125 x 0.125 mm (1 mm = 8 dots)	0.084 x 0.084 mm (1 mm = 12 dots)
<b>Print speed (inches per second)</b>	Up to 6 ips	Up to 4 ips
	Max. 3 ips for peeler mode	
<b>Max. print width</b>	108 mm (4.25")	105.6 mm (4.15")
<b>Max. print length</b>	25,400 mm (1000")	11,430 mm (450")
<b>Printout bias</b>	Vertical: 1 mm max. Horizontal: 1 mm max.	

## 1.5 Ribbon Specifications

<b>Ribbon Specifications</b>	
<b>Ribbon outside diameter</b>	Max. 40 mm OD
<b>Ribbon length</b>	110 meter
<b>Ribbon core inside diameter</b>	0.5" ID core
<b>Ribbon width</b>	40 mm ~110 mm
<b>Ribbon wound type</b>	Ink coated outside wound

## 1.6 Media Specifications

Media Specifications	
<b>Media roll capacity</b>	Max. 5" OD
<b>Media core diameter</b>	1" & 1.5 ID core
<b>Media type</b>	Continuous, die-cut, black mark, external fan-fold, notch
<b>Media wound type</b>	Outside wound
<b>Media width</b>	20 mm ~ 112 mm
<b>Media thickness</b>	0.06 mm ~ 0.19 mm
<b>Label length</b>	10 mm ~ max. print length
<b>Label length (peeler mode)</b>	25.4 mm ~ 152.4 mm (1" ~ 6")
<b>Label length (cutter mode)</b>	25.4 ~ max. print length
<b>Black mark</b>	Min. 8 mm (W) x 2 mm (H)
<b>Gap height</b>	Min. 2 mm

## 2. Operations Overview

---

### 2.1 Unpacking and Inspection

This printer has been specially packaged to withstand damage during shipping. Please carefully inspect the packaging and printer upon receiving the bar code printer. Please retain the packaging materials in case you need to reship the printer.

Unpacking the printer, the following items are included in the carton.

- One printer unit
- One Windows labeling software/Windows driver CD disk
- One quick installation guide
- One power cord
- One auto switching power supply
- One USB interface cable

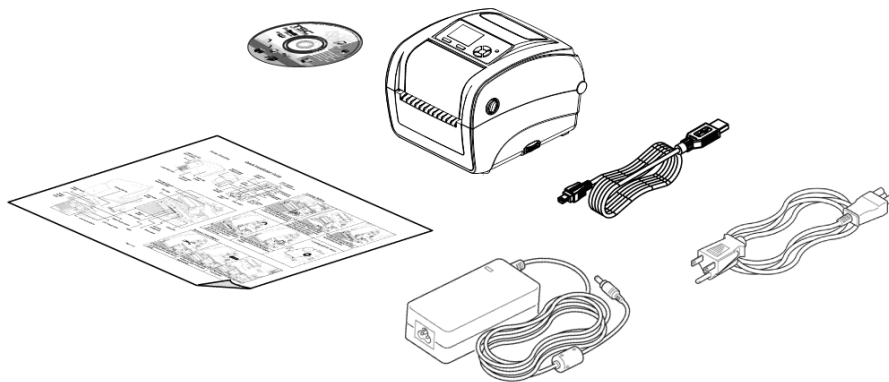

If any parts are missing, please contact the Customer Service Department of your purchased reseller or distributor.

## 2.2 Printer Overview

### 2.2.1 Front View

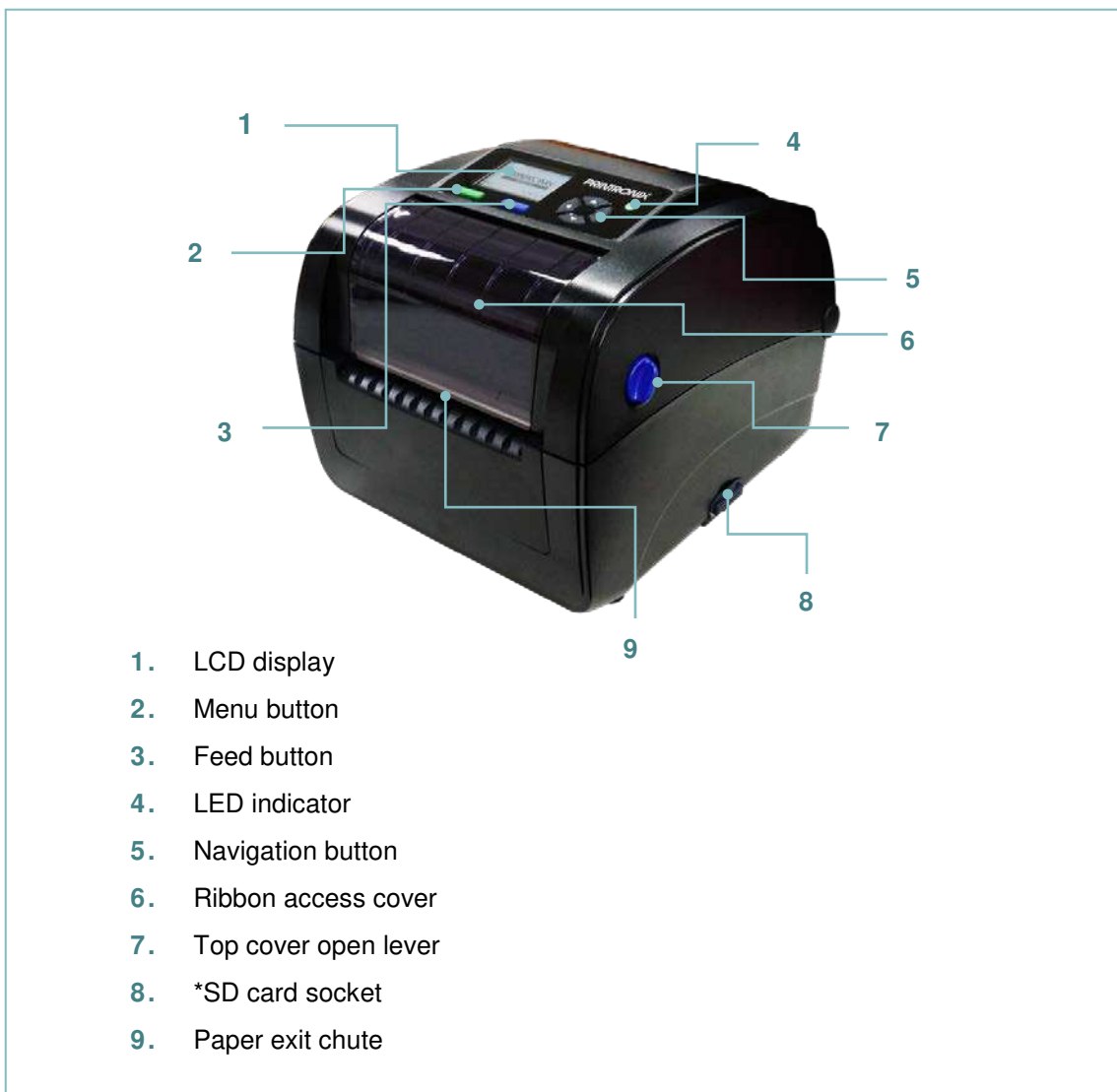

#### \* Recommended SD card specification

SD card spec	SD card capacity	Approved SD card manufacturer
V2.0 SDHC CLASS 4	2 GB	Transcend
V2.0 SDHC CLASS 4	8 GB	SanDisk
V3.0 CLASS 10 UHS	16 GB	SanDisk
V3.0 CLASS 10 UHS	32 MB	Transcend
V2.0 SDHC CLASS 4	microSD 4GB	Transcend
V2.0 SDHC CLASS 4	microSD 16 GB	SanDisk
V3.0 CLASS 10 UHS	microSD 16GB	Transcend, Kingston
V3.0 CLASS 10 UHS	microSD 32 GB	SanDisk

- The DOS FAT file system is supported for the SD card.  
 - Folders/files stored in the SD card should be in the 8.3 filename format  
 - The miniSD/microSD card to SD card slot adapter is required.

## 2.2.2 Interior view

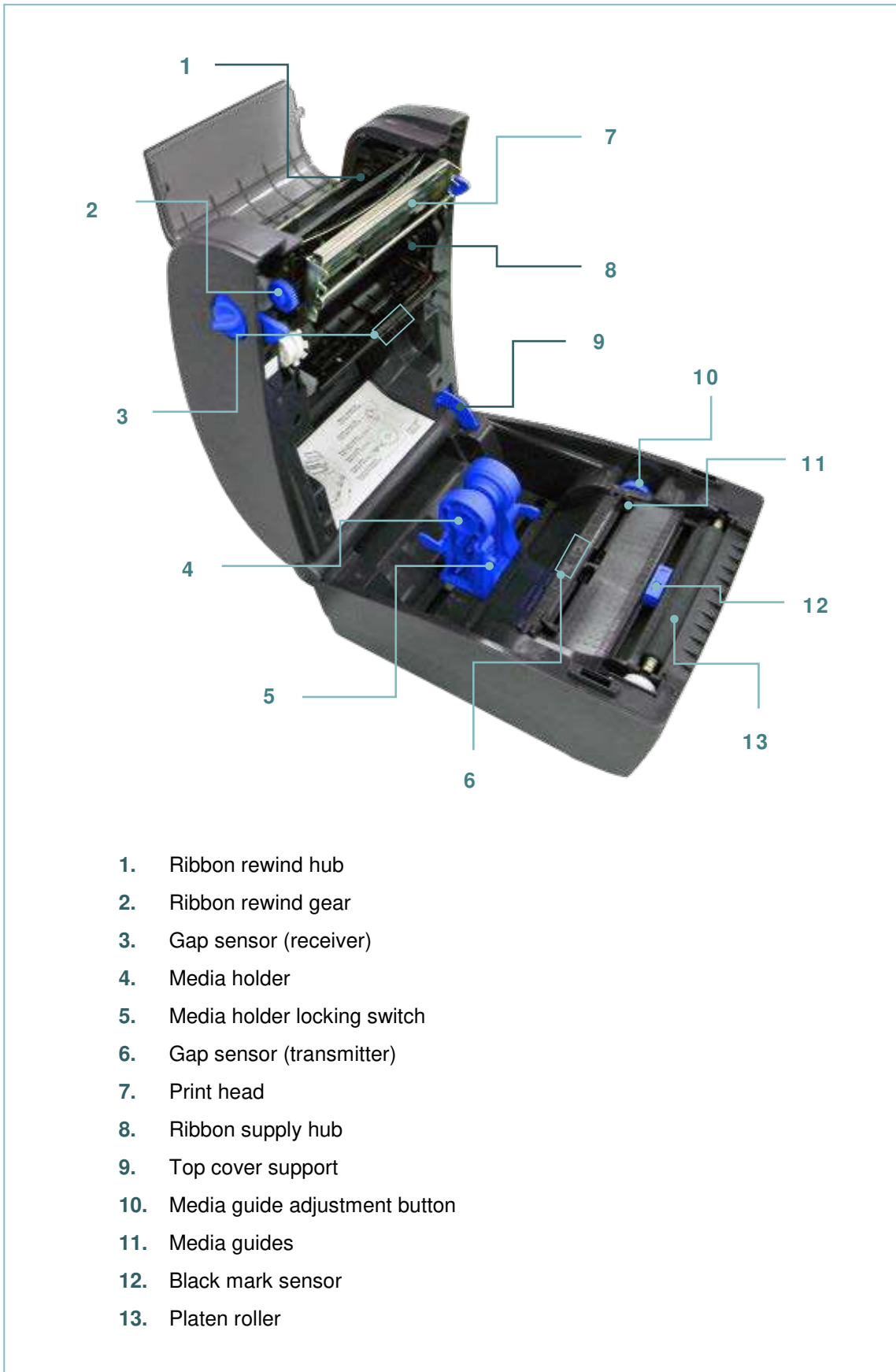



### 2.2.3 Rear View



1. Ethernet interface
2. USB interface
3. USB host
4. RS-232C interface
5. Power jack socket
6. Power switch
7. External label entrance chute

**The interface picture here is for reference only. Please refer to the product specification for the interfaces availability.**

## 2.3 Operator Control

### 2.3.1 LED Indication

This printer has one three-color LED indicator.

LED Color	Description
Green/ Solid	This illuminates that the power is on and the device is ready to use.
Green/ Flash	This illuminates that the system is downloading data from PC to memory or the printer is paused.
Amber	This illuminates that the system is clearing data from printer.
Red / Solid	This illuminates printer head open, cutter error.
Red / Flash	This illuminates a printing error, such as head open, paper empty, paper jam, or memory error etc.

### 2.3.2 Button Function

- **Feed button**
  - When the printer is ready, press the button to feed one label to the beginning of next label
  - When the printer is printing, press the button to pause a print job. When the printer is paused the power LED will blink green. Press the button again to continue the printing job
  - When printer enter the menu, press the button to enter/select cursor located item
- **Menu button**
  - Enter the menu
  - Exit from a menu or cancel a setting and return to the previous menu
- **Navigation button**
  - Scroll the menu list

## 3. Setup

---

### 3.1 Setting up the printer

1. Place the printer on a flat, secure surface.
2. Make sure the power switch is off.
3. Connect the printer to the computer with the provided USB cable.
4. Plug the power cord into the AC power cord socket at the rear of the printer, and then plug the power cord into a properly grounded power outlet.

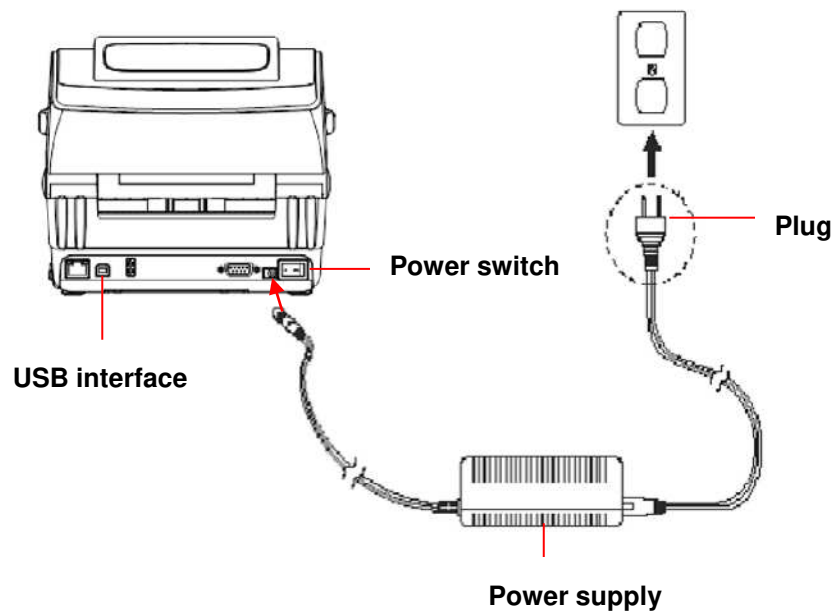

**Note:** Please switch OFF printer power switch prior to plug in the power cord to printer power jack.

### 3.2 Open/Close the Top Cover



1. Open the printer's top cover by pulling the top cover open levers located on each side of the printer and lifting the top cover to the maximum open angle.



2. A top cover support at the rear of the printer will engage with lower inner cover to hold the printer top cover open.



3. Hold the top cover and press the top cover support to disengage the top cover support with lower inner cover. Gently close the top cover.

### 3.3 Loading the Ribbon



1. Open the printer's top cover by pulling the top cover open levers located on each side of the printer and lifting the top cover to the maximum open angle.



2. Open the ribbon access cover and the media cover.

**Note:**

1. In normal printing mode, ribbon access cover can be opened while opens the top cover. Ribbon access cover can be closed while top cover is open or close.
2. In peeler and cutter mode, please open the top cover then the ribbon access cover can be opened or closed.



3. Insert the ribbon right side onto the supply hub. Align the notches on the left side and mount onto the spokes.



4. Insert the paper core right side onto the rewind hub. Align the notches on the left side and mount onto the spokes.

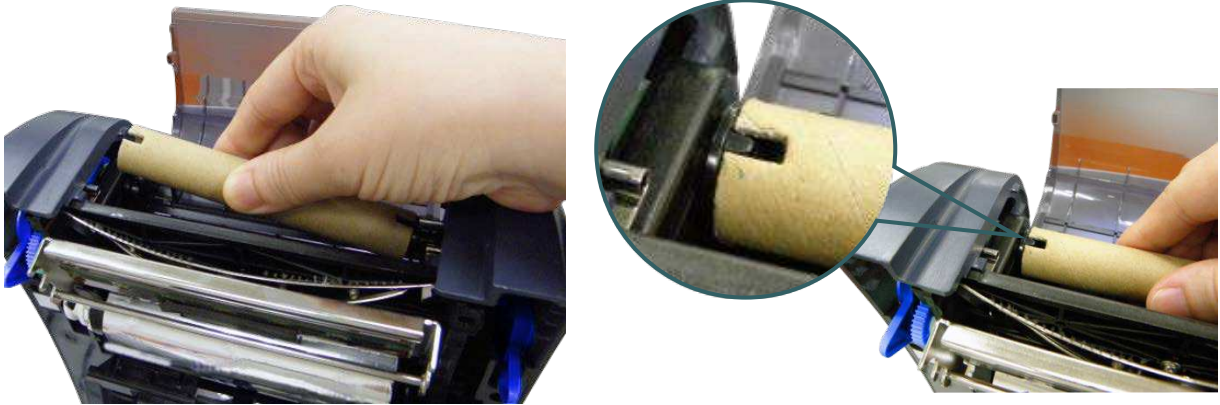

5. Stick the ribbon onto the ribbon rewind paper core.



6. Turn the ribbon rewind gear until the ribbon plastic leader is thoroughly wound and the black section of the ribbon covers the print head.



7. Close the ribbon access cover and the top cover.

---

### Loading path for ribbon

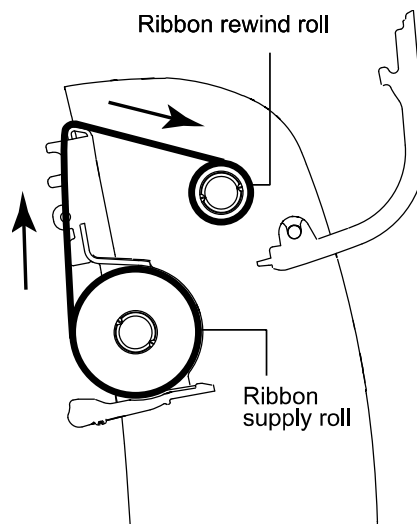

## 3.4 Loading the Media

### 3.4.1 Loading the Media



1. Open the printer top cover by pulling the tabs located on each side towards the front of the printer then lift the top cover to the maximum open angle.



2. Separate and hold open the media holders.



3. Place the roll between the holders and close them onto the core.





4. Press down the media holder lock switch to hold the label roll firmly.

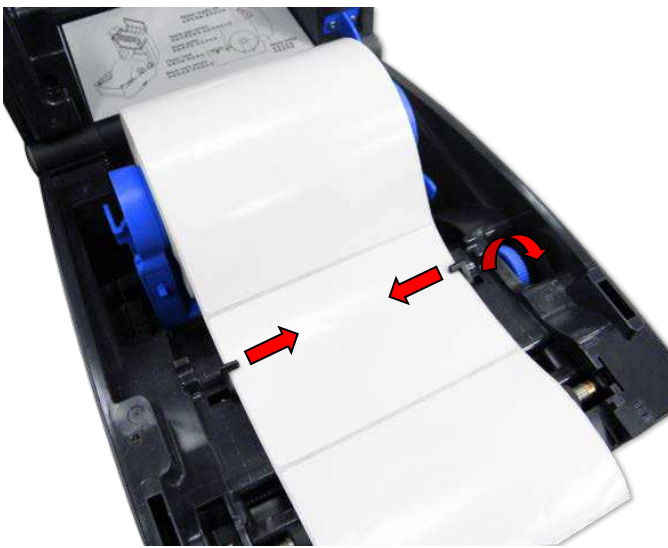

5. Place the paper, printing side face up, through the media sensor and place the label leading edge onto the platen roller. Move the media guides to fit the label width by turning the guide adjuster knob.



6. Disengage the top cover support and close the top cover gently.

- 
7. Use “Configuration Utility” or LCD menu function to set the media sensor type and calibrate the selected sensor.

**For Configuration Utility:**

Start the “Configuration Utility” → Select the “T6X0” in the list → Click the “Printer Function” button → Click the “Calibrate” button → Select media sensor type and Click the “Calibrate” button

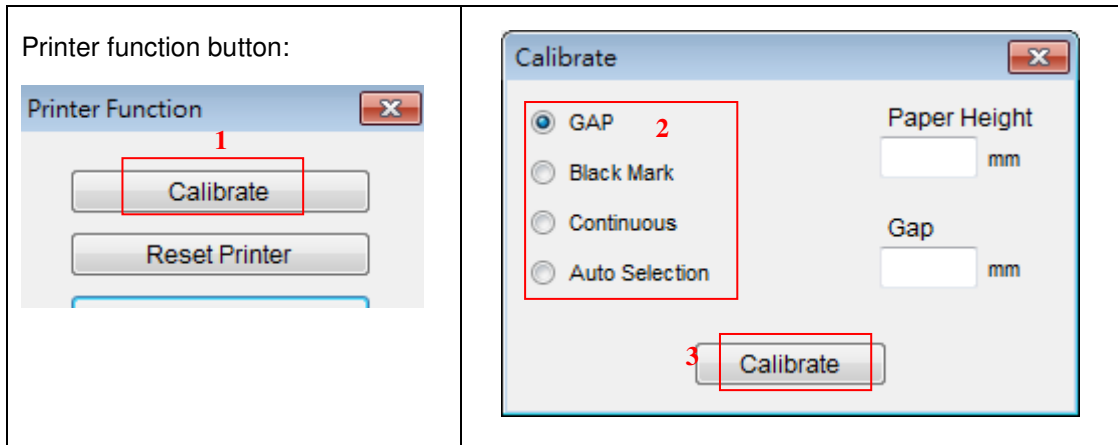

**Note:**

- Please calibrate the gap/black mark sensor when changing media.
- Please refer to the section 6 for LCD menu function.

---

**Loading path for media**

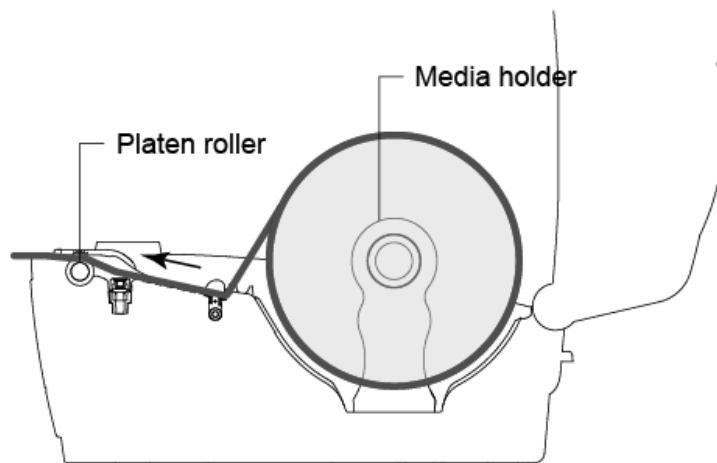

### 3.4.2 External Label Roll Mount Installation (Option)

1. Attach an external paper roll mount on the bottom of the printer.

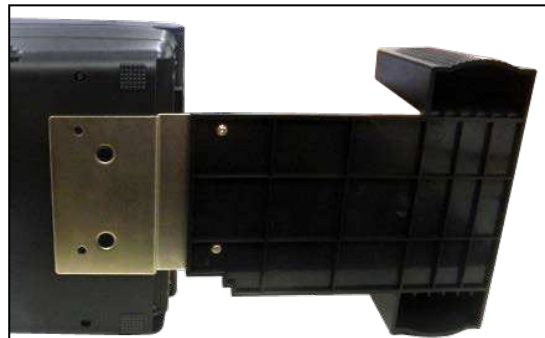

2. Insert a 3" label spindle into a paper roll. And install it on the external paper roll mount.

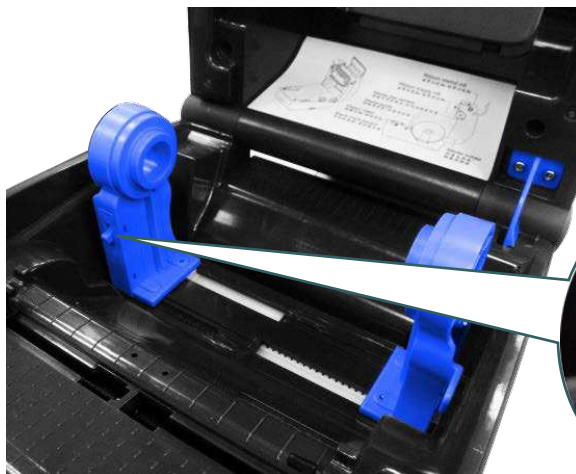

3. Open the printer's top cover and separate the media holders to fit the media width. Press down the media holder lock switch to fix the media holder.



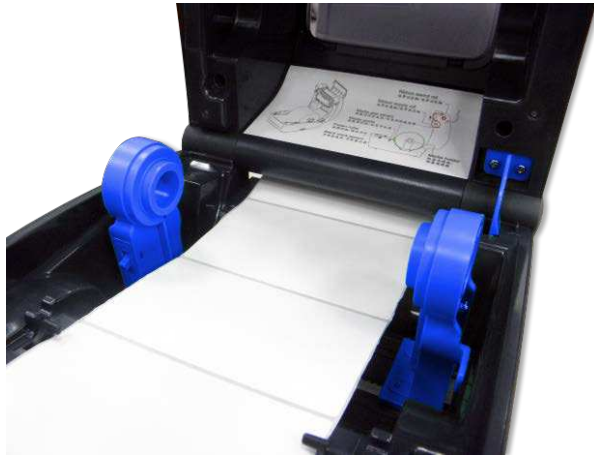

4. Feeds the media through the rear external label entrance chute. And place the paper, printing side face up, through the media sensor and place the label leading edge onto the platen roller. Move the media guides to fit the label width by turning the guide adjuster knob.



5. Disengage the top cover support and close the top cover gently.
6. Use "Configuration Utility" or LCD menu function to set the media sensor type and calibrate the selected sensor.

#### For Configuration Utility:

Start the "Configuration Utility" → Select the "T6X0" in the list → Click the "Printer Function" button → Click the "Calibrate" button → Select media sensor type and Click the "Calibrate" button

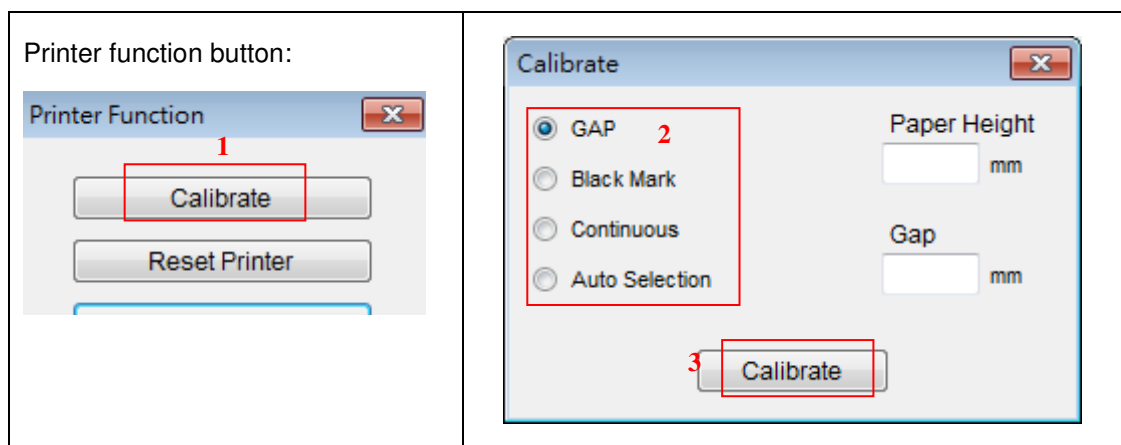

#### Note:

- Please calibrate the gap/black mark sensor when changing media.
- Please refer to the section 6 for LCD menu function.

### 3.4.3 Loading Media in Peel-off Mode (Option)

1. Please refer to section 3.3.1 to load the media.
2. Use "Configuration Utility" or LCD menu function to set the media sensor type and calibrate the selected sensor.

**Note:**

- Please calibrate the gap/black mark sensor before loading media in peel-off mode to avoid paper jam.
- Please calibrate the gap/black mark sensor when changing media.

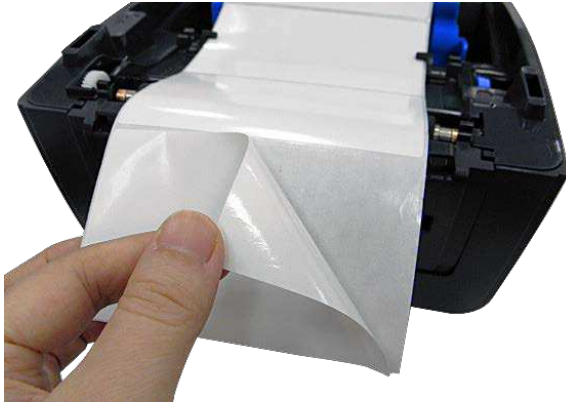

3. Open the printer cover. Pull the label through the front of the printer and take some labels off only leave the liner.

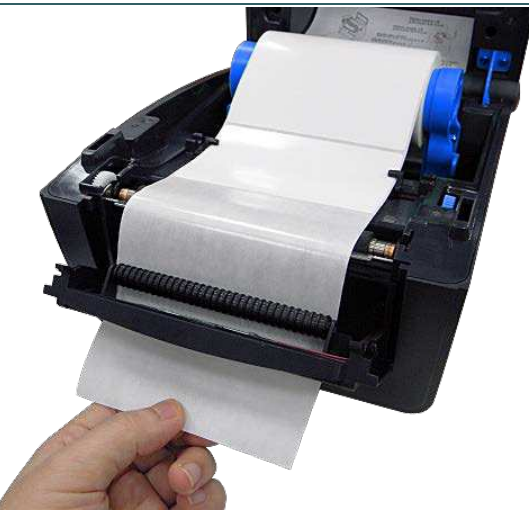

4. Open the peel-off module cover. Feed the liner into peel-off cover slot.

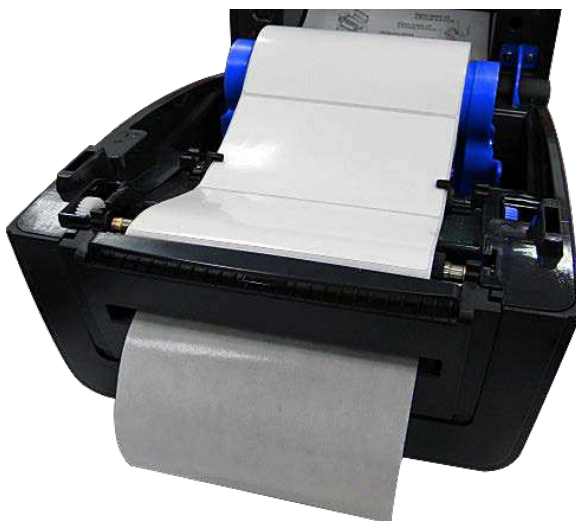

5. Close the peel-off module. Use the Configuration Utility or LCD menu function to enable the peel-off mode.

**For Configuration Utility:**

Start the "Configuration Utility" → Select the "T6X0" in the list → Click the "Printer Configuration" button → Select "PEEL" for Post-Print Action on "Basic" tab → Click "Set" button

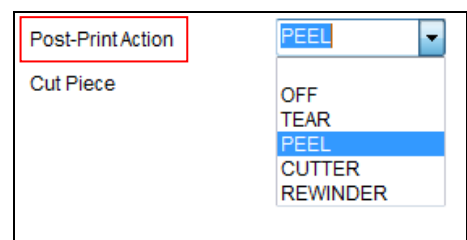



6. Disengage the top cover support to close the top cover. Printer is ready for peel-off mode.
7. Press the FEED button to test.

**Note:**

**This peel-off module is supported for the thermal/plain label only.**

### 3.4.4 Loading Media in Cutter Mode (Option)

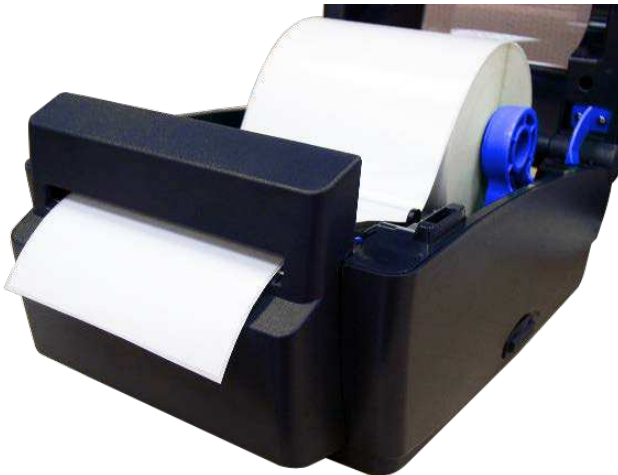

1. Please refer to section 3.3.1 to load the media.
2. Lead the media through the cutter paper opening.

3. Close the printer cover.
4. Use "Configuration Utility" or LCD menu function to enable the cutter mode.

#### For Configuration Utility:

Start the "Configuration Utility" → Select the "T6X0" in the list → Click the "Printer Configuration" button → Select "CUTTER" for Post-Print Action on "Basic" tab → Click "Set" button

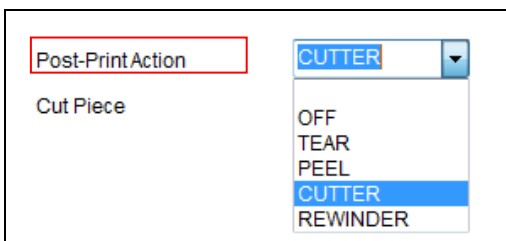

5. Use "Configuration Utility" or LCD menu function to set the media sensor type and calibrate the selected sensor.

#### For Configuration Utility:

Start the "Configuration Utility" → Select the "T6X0" in the list → Click the "Printer Function" button → Click the "Calibrate" button → Select media sensor type and Click the "Calibrate" button

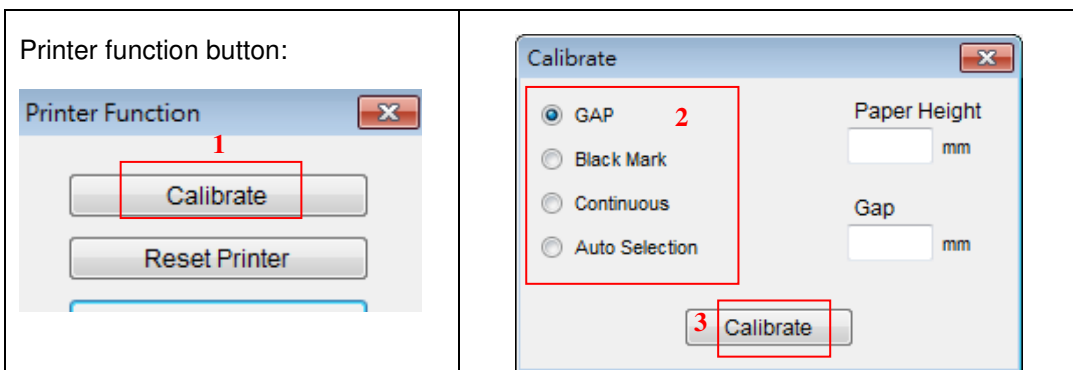

6. Press the FEED button to test.

#### Note:

- Please calibrate the gap/black mark sensor when changing media.
- Please refer to the section 6 for LCD menu function.

## 4. Configuration Utility

Configuration Utility is an integrated tool incorporating features that enable you to explore a printer's settings/status; change a printer's settings; download graphics, fonts and firmware; create a printer bitmap font; and send additional commands to a printer. With the aid of this powerful tool, you can review printer status and setting in an instant, which makes it much easier to troubleshoot problems and other issues.

### 4.1 Start the Configuration Utility

1. Connect the USB cable between the computer and the printer.
2. Turn on the printer power.
3. Start the Configuration Utility by double clicking on the  icon.
3. The main interface will list all of the printer, including all printer that through USB interface connected to the computer, and all the printer that exist the same subnet with computer.
4. Select the printer in the list then click the button to enter the setting page.

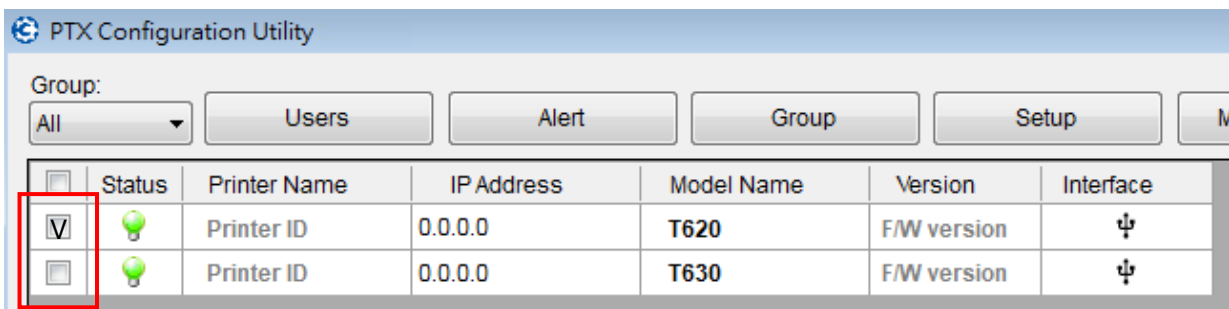

5. The detail functions in the bottom of the main interface are listed as below.



Function	Description
Printer Configuration	This feature is used to set/explore/configure the printer settings. The common setting includes the settings that commonly used for TSPL/EPL2/ZPL/DPL printer languages.
File Manager	File manager feature is to help users to generate the file header, download the file into printer, explore what files are downloaded in printer memory and delete all files in the memory.
Command Tool	The additional features that are not yet supported in the printer management can be achieved by sending out printer commands





	to printer from the Command Tool.
RTC Setup	This feature is to synchronize printer Real Time Clock with PC.
Printer Function	This feature is used to calibrate the sensor, initialization, ignore AUTO.BAS ... etc.
Bitmap Font Manager	Bitmap font manager is used to convert the selected TTF font into printer format bitmap font. Both fixed pitch and variable pitch bitmap font are supported.

## 4.2 Printer Function Button

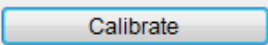

Click the “Printer Function” button.

The detail functions in the Printer Function Group are listed as below.

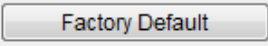
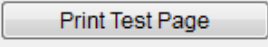
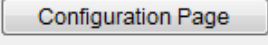
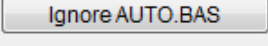
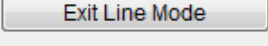
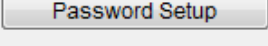
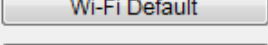
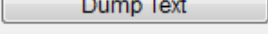
	Function	Description
	Calibrate	Calibrate the sensor specified in the Printer Setup group media sensor field
	Reset Printer	Reboot printer
	Factory Default	Initialize the printer and restore the settings to factory default.
	Print Test Page	Print a test page
	Configuration Page	Print printer configuration
	Ignore AUTO.BAS	Ignore the downloaded AUTO.BAS program
	Exit Line Mode	Exit line mode.
	Password Setup	Set the password to protect the settings
	Wi-Fi Default	Initialize the printer Wi-Fi module to default settings
	Dump Text	To activate the printer dump mode.

**Note:**

For more information about Configuration Utility, please refer to the Configuration Utility quick start guide in the CD disk \Config\_UTILITY directory.

### 4.3 Setting Ethernet using Configuration Utility

The Configuration Utility is enclosed in the CD disk \Config\_Utility directory. Users can use Configuration to setup the Ethernet by USB interface. The following steps instruct users on configuring the Ethernet interface.

1. Connect the USB cable and Ethernet cable between the computer and the printer.
2. Turn on the printer power.
3. Start the Configuration Utility by double clicking on the  icon.
4. The main interface will list all of the printer, including all printer that through USB interface connected to the computer, and all the printer that exist the same subnet with computer.

**Note: The default IP address is obtained by DHCP. If the printer exist the same subnet with computer, the Configuration Utility main interface will list as below,**

<input type="checkbox"/>	Status	Printer Name	IP Address	Model Name	Version	Interface
<input type="checkbox"/>		PS-32B7E8	10.0.10.157	T620	A1.97.1 EZ	→ USB
<input type="checkbox"/>		PS-32B7E8	10.0.10.157	T620	A1.97.1 EZ	→ Ethernet

5. Select the printer (interface) in the list then click the button to enter the setting page.

<input type="checkbox"/>	Status	Printer Name	IP Address	Model Name	Version	Interface
<input checked="" type="checkbox"/>		PS-32B7E8	10.0.10.157	T620	A1.97.1 EZ	
<input type="checkbox"/>		PS-32B7E8	10.0.10.157	T620	A1.97.1 EZ	

6. Click the “Printer Configuration” button.



7. Select the “Ethernet” tab for the on board Ethernet. A printer’s IP address is assigned by DHCP server. To change the setting to static IP address, click “Static IP” radio button then enter the IP address, subnet mask and gateway. Click “Set IP” for the settings to take effect.

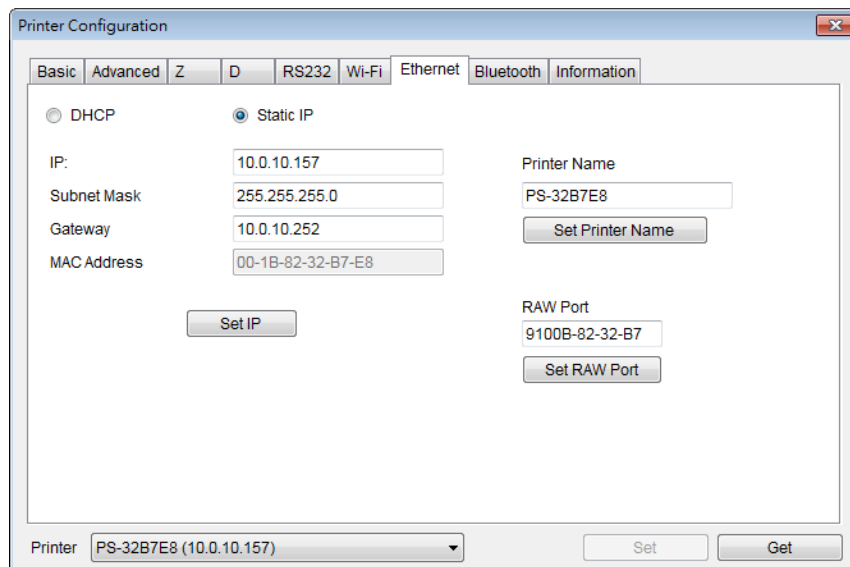

Users can also change the “Printer Name” by entering the new name in the box, then click “Set Printer Name” for the change to take effect.

***Note: After clicking the “Set Printer Name” or “Set IP” button, printer will reset in order for the new setting to take effect.***

## 5. Power-on Utilities

---

There are six power-on utilities to set up and test printer hardware. These utilities are activated by pressing FEED button then turning on the printer power simultaneously and release the button at different status of LED.

Please follow the steps below for different power-on utilities.

1. Turn off the printer power switch.
2. Hold on the button then turn on the power switch.
3. Release the button when LED indicates with different status (color) for different functions.

<b>Power on utilities</b>	<b>The LED color will be changed as following pattern:</b>							
<b>LED color</b>	Green	Amber	Red	Amber	Green	Green/Amber	Red/Amber	Solid green
<b>Functions</b>			(5 blinks)	(5 blinks)	(5 blinks)	(5 blinks)	(5 blinks)	
<b>Ribbon sensor calibration and gap / black mark sensor calibration</b>			<i>Release</i>					
<b>Gap / black mark sensor calibration, Self-test and enter dump mode</b>				<i>Release</i>				
<b>Printer initialization</b>					<i>Release</i>			
<b>Set black mark sensor as media sensor and calibrate the black mark sensor</b>						<i>Release</i>		
<b>Set gap sensor as media sensor and calibrate the gap sensor</b>							<i>Release</i>	
<b>Skip AUTO.BAS</b>								<i>Release</i>

## 5.1 Ribbon and Gap/Black Mark Sensor Calibration

Gap/black mark sensor sensitivity should be calibrated at the following conditions:

1. A brand new printer
2. Change label stock
3. Printer initialization

Please follow the steps below to calibrate the ribbon and gap/black mark sensor.

1. Turn off the power switch.
2. Hold on the button then turn on the power switch.
3. Release the button when LED becomes **red** and blinking. (Any red will do during the 5 blinks)

- It will calibrate the ribbon sensor and gap/black mark sensor sensitivity.
- The LED color will be changed as following order :

Green → amber → **red (5 blinks)** → amber (5 blinks) → green (5 blinks) → green/amber (5 blinks) → red/amber (5 blinks) → solid green

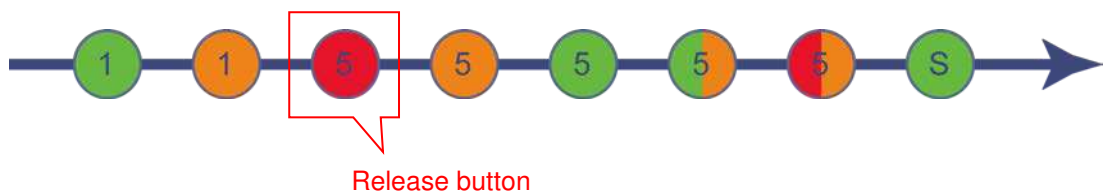

### Note:

Please select gap or black mark sensor by sending **GAP** or **BLINE** command to printer prior to calibrate the sensor.

For more information about **GAP** and **BLINE** command, please refer to **TSPL2 programming manual**.

## 5.2 Gap/Black Mark Calibration, Self-test and Dump Mode

While calibrate the gap/black mark sensor, printer will measure the label length, print the internal configuration (self-test) on label and then enter the dump mode. To calibrate gap or black mark sensor, depends on the sensor setting in the last print job.

Please follow the steps below to calibrate the sensor.

1. Turn off the power switch.
2. Hold on the button then turn on the power switch.
3. Release the button when LED becomes **amber** and blinking. (Any amber will do during the 5 blinks)
  - The LED will be changed as following order.  
Green → amber → red (5 blinks) → **amber (5 blinks)** → green (5 blinks) → green/amber (5 blinks) → red/amber (5 blinks) → solid green

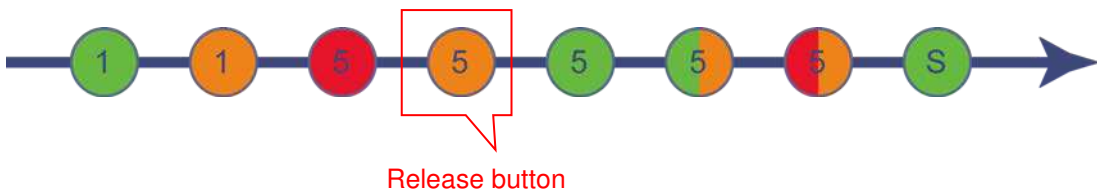

4. It calibrates the sensor and measures the label length and prints internal settings then enter the dump mode.

### Note:

Please select gap or black mark sensor by Configuration Utility or by GAP or BLINE command prior to calibrate the sensor.

For more information about GAP and BLINE command, please refer to TSPL2 programming manual.

## ■ Self-test

Printer will print the printer configuration after gap/black mark sensor calibration. Self-test printout can be used to check if there is any dot damage on the heater element, printer configurations and available memory space.

Self-test printout	
<pre> ----- SYSTEM INFORMATION ----- MODEL: XXXXXX FIRMWARE: X.XX CHECKSUM: XXXXXXXX S/N: XXXXXXXXXXXX TCF: NO DATE: 1970/01/01 TIME: 00:04:18 NON-RESET: 110 m (TPH) RESET: 110 m (TPH) NON-RESET: 0 (CUT) RESET: 0 (CUT) ----- </pre>	<ul style="list-style-type: none"> <li>Model name</li> <li>F/W version</li> <li>Firmware checksum</li> <li>Printer S/N</li> <li>Configuration file</li> <li>System date</li> <li>System time</li> <li>Printed mileage (meter)</li> <li>Cutting counter</li> </ul>
<pre> ----- PRINTING SETTING ----- SPEED: 5 IPS DENSITY: 8.0 WIDTH: 4.00 INCH HEIGHT: 4.00 INCH GAP: 0.00 INCH INTENSION: 5 CODEPAGE: 850 COUNTRY: 001 ----- </pre>	<ul style="list-style-type: none"> <li>Print speed (inch/sec)</li> <li>Print darkness</li> <li>Label size (inch)</li> <li>Gap distance (inch)</li> <li>Gap/black mark sensor intension</li> <li>Code page</li> <li>Country code</li> </ul>
<pre> ----- Z SETTING ----- DARKNESS: 16.0 SPEED: 4 IPS WIDTH: 4.00 INCH TILDE: 7EH (~)  CARET: 5EH (^) DELIMITER: 2CH (,) POWER UP: NO MOTION HEAD CLOSE: NO MOTION ----- </pre>	<ul style="list-style-type: none"> <li>ZPL setting information</li> <li>Print darkness</li> <li>Print speed (inch/sec)</li> <li>Label size</li> <li>Control prefix</li> <li>Format prefix</li> <li>Delimiter prefix</li> <li>Printer power up motion</li> <li>Printer head close motion</li> </ul> <p><b>Note:</b> ZPL is emulating for Zebra® language.</p>
<pre> ----- RS232 SETTING ----- BAUD: 9600 PARITY: NONE DATA BIT: 8 STOP BIT: 1 ----- </pre>	<ul style="list-style-type: none"> <li>RS232 serial port configuration</li> </ul>

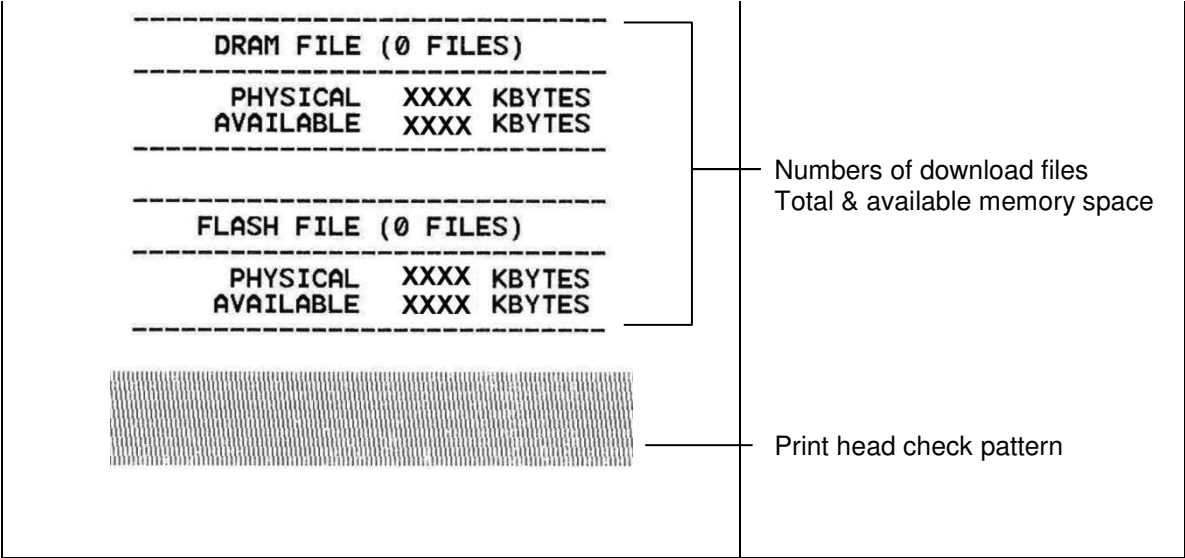



## ■ Dump mode

Printer will enter dump mode after printing printer configuration. In the dump mode, all characters will be printed in 2 columns as following. The left side characters are received from your system and right side data are the corresponding hexadecimal value of the characters. It allows users or engineers to verify and debug the program.

ASCII Data	→	<pre> SPEED 2.0 53 50 45 45 44 20 32 2E 30 0D DENSITY 8 0A 44 45 4E 53 49 54 59 20 38 SET PEEL 0D 0A 53 45 54 20 50 45 45 4C OFF DIRE 20 4F 46 46 0D 0A 44 49 52 45 CTION 0 0 43 54 49 4F 4E 20 30 0D 0A 47 AP 3.00 mm 41 50 20 33 2E 30 30 20 6D 0D .00 mm 2C 30 2E 30 30 20 6D 6D 0D 0A REFERENCE 52 45 46 45 52 45 4E 43 45 20 0.0 SET C 30 2C 30 0D 0A 53 45 54 20 43 UTTER OFF 55 54 54 45 52 20 4F 46 46 0D SIZE 100. 0A 53 49 5A 45 20 31 30 30 2E 02 mm.65.0 30 32 20 6D 6D 2C 36 35 2E 30 4 mm CLS 34 20 6D 6D 0D 0A 43 4C 53 0D BARCODE 1 0A 42 41 52 43 4F 44 45 20 31 44.149.39 34 34 2C 31 34 39 2C 22 33 39 .120.1.0. 22 2C 31 32 30 2C 31 2C 30 2C 2.6."57114 32 2C 36 2C 22 35 37 31 31 34 38T" PRIN 33 38 54 22 0D 0A 50 52 49 4E T 1.1 SPE 54 20 31 2C 31 0D 0A 53 50 45 ED 2.0 DE 45 44 20 32 2E 30 0D 0A 44 45 NSITY 8 S 4E 53 49 54 59 20 38 0D 0A 53  ET PEEL OF 45 54 20 50 45 45 4C 20 4F 46 F DIRECTI 46 0D 0A 44 49 52 45 43 54 49 ON 0 GAP 4F 4E 20 30 0D 0A 47 41 50 20 3.00 mm.0. 33 2E 30 30 20 6D 6D 2C 30 2E 00 mm REF 30 30 20 6D 6D 0D 0A 52 45 46 ERENCE 0.0 45 52 45 4E 43 45 20 30 2C 30 SET CUTT 0D 0A 53 45 54 20 43 55 54 54 ER OFF SI 45 52 20 4F 46 46 0D 0A 53 49 ZE 100.02 5A 45 20 31 30 30 2E 30 32 20 mm.65.04 m 6D 6D 2C 36 35 2E 30 34 20 6D m CLS BA 6D 0D 0A 43 4C 53 0D 0A 42 41 RODE 144. 52 43 4F 44 45 20 31 34 34 2C 149.39".1 31 34 39 2C 22 33 39 22 2C 31 20.1.0.2.0 32 30 2C 31 2C 30 2C 32 2C 36 ."5711438T 2C 22 35 37 31 31 34 33 38 54 .1 PRINT 1 22 0D 0A 50 52 49 4E 54 20 31 .1 2C 31 0D 0A </pre>	←	Hex decimal data related to left column of ASCII data
------------	---	---	---	---

### Note:

1. Dump mode requires 4" wide paper width.
2. Turn off / on the power to resume printer for normal printing.

### 5.3 Printer Initialization

Printer initialization is used to clear DRAM and restore printer settings to defaults. The only one exception is ribbon sensitivity, which will not be restored to default.

Printer initialization is activated by the following procedures.

1. Turn off the power switch.
2. Hold on the button then turn on the power switch.
3. Release the button when LED turns **green** after 5 amber blinks. (Any green will do during the 5 blinks)
  - The LED will be changed as following:  
 Green → amber → red (5 blinks) → amber (5 blinks) → **green (5 blinks)** → green/amber (5 blinks)  
 → red/amber (5 blinks) → solid green



Printer configuration will be restored to defaults as below after initialization.

Parameter	Default setting
Speed	127 mm/sec (5 ips) (203DPI) 76 mm/sec (3 ips) (300DPI)
Density	8
Label Width	4" (101.5 mm)
Label Height	4" (101.5 mm)
Sensor Type	Gap sensor
Gap Setting	0.12" (3.0 mm)
Print Direction	0
Reference Point	0,0 (upper left corner)
Offset	0
Tear Mode	On
Peel off Mode	Off
Cutter Mode	Off
Serial Port Settings	9600 bps, none parity, 8 data bits, 1 stop bit
Code Page	850
Country Code	001
Clear Flash Memory	No
IP Address	DHCP

## 5.4 Set Black Mark Sensor as Media Sensor and Calibrate the Black Mark Sensor

Please follow the steps as below.

1. Turn off the power switch.
2. Hold on the button then turn on the power switch.
3. Release the button when LED turns **green/amber** after 5 green blinks. (Any green/amber will do during the 5 blinks).

- The LED will be changed as following:

Green → amber → red (5 blinks) → amber (5 blinks) → green (5 blinks) → **green/amber (5 blinks)**  
→ red/amber (5 blinks) → solid green

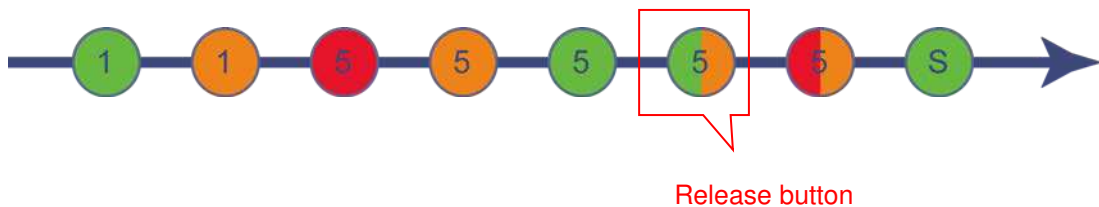

## 5.5 Set Gap Sensor as Media Sensor and Calibrate the Gap Sensor

Please follow the steps as below.

1. Turn off the power switch.
2. Hold on the button then turn on the power switch.
3. Release the button when LED turns **red/amber** after 5 green/amber blinks. (Any red/amber will do during the 5 blinks).

- The LED will be changed as following:

Green → amber → red (5 blinks) → amber (5 blinks) → green (5 blinks) → green/amber (5 blinks) → **red/amber (5 blinks)** → solid green

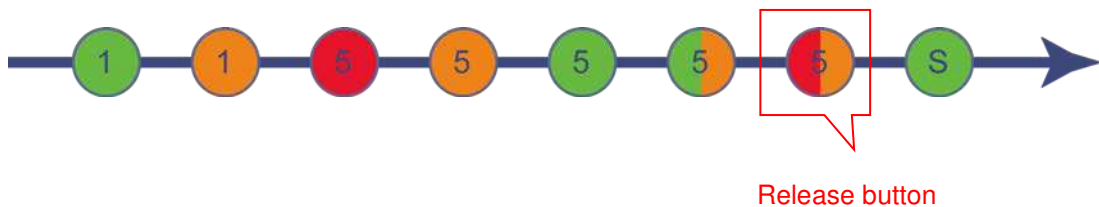

## 5.6 Skip AUTO.BAS

TSPL2 programming language allows user to download an auto execution file to flash memory. Printer will run the AUTO.BAS program immediately when turning on printer power. The AUTO.BAS program can be interrupted without running the program by the power-on utility.

Please follow the procedures below to skip an AUTO.BAS program.

1. Turn off printer power.
2. Press the FEED button and then turn on power.
3. Release the FEED button when LED becomes **solid green**.

- The LED will be changed as following:

Green → amber → red (5 blinks) → amber (5 blinks) → green (5 blinks) → green/amber (5 blinks) → red/amber (5 blinks) → **solid green**

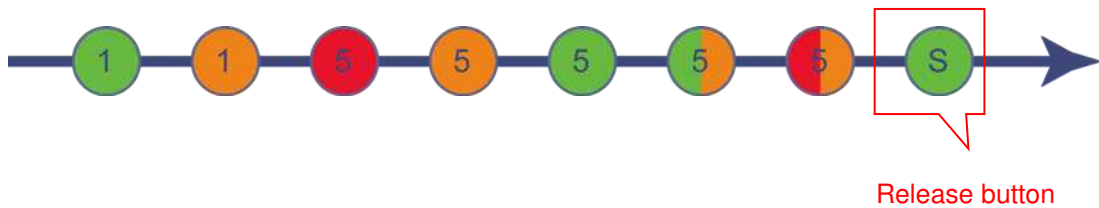

4. Printer will be interrupted to run the AUTO.BAS program.

## 6. LCD Menu Function

### 6.1 Enter the Menu

Press the “Menu” button to enter the main menu. Use the “Cross” buttons to navigate on the main menu. The selected item turns blue background. Press the “Feed/Select” button to enter the setting list.

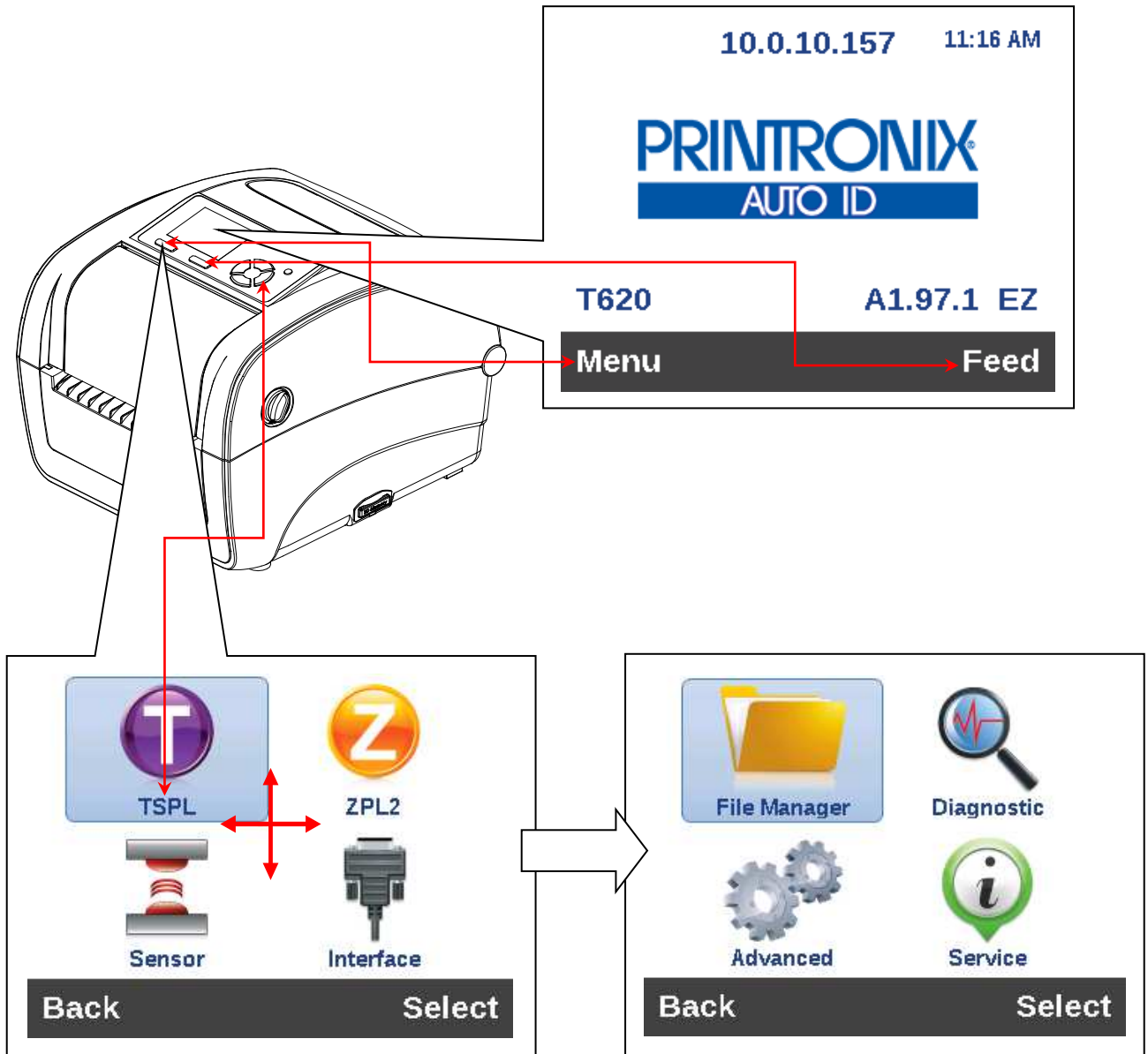

## 6.2 Main Menu Overview

There are 8 categories for the main menu. You can easily set the settings of printer without connecting the computer. Please refer to following sections for more details.

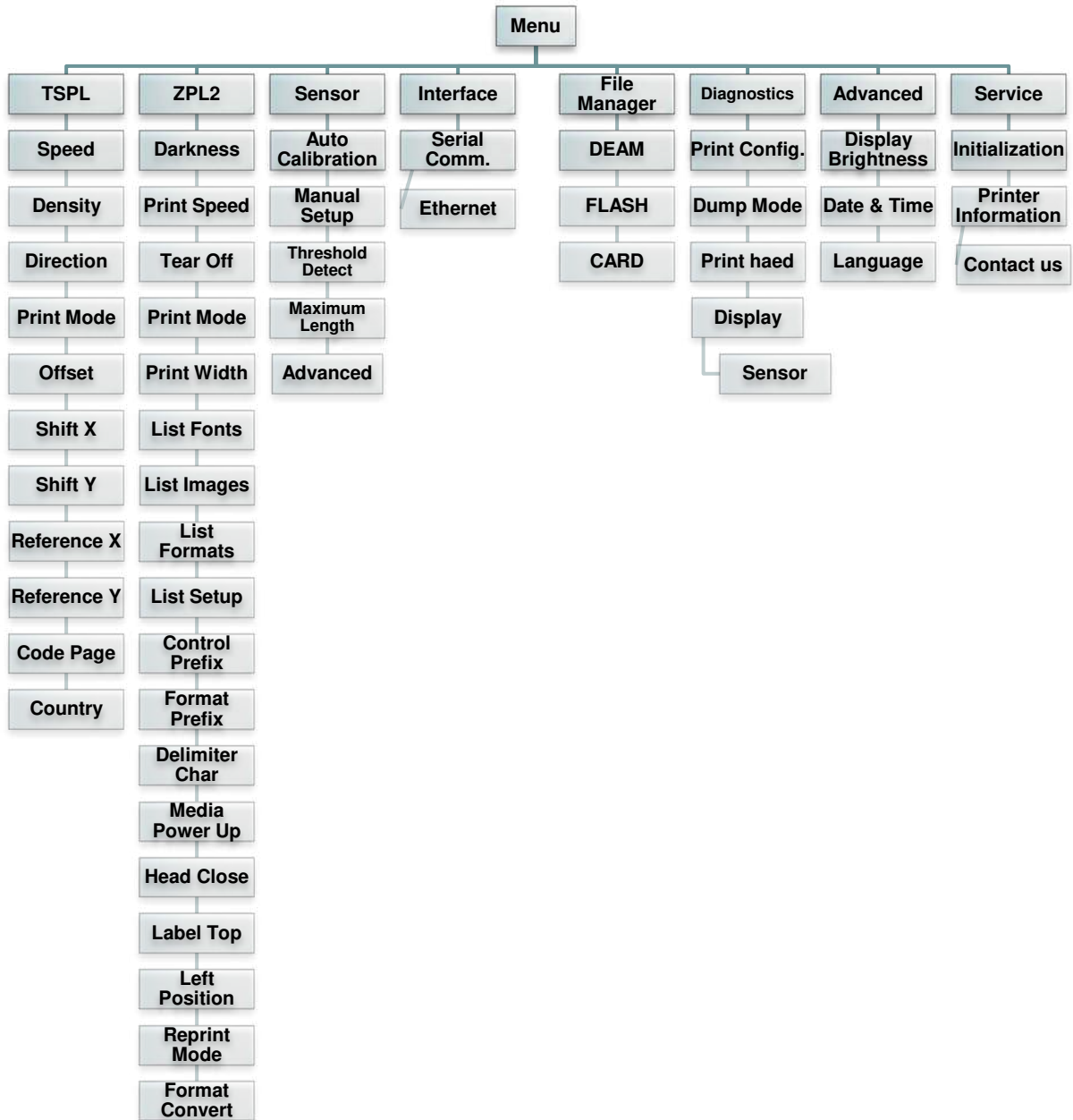

### 6.3 TSPL

This “TSPL” category can set up the printer settings for TSPL.

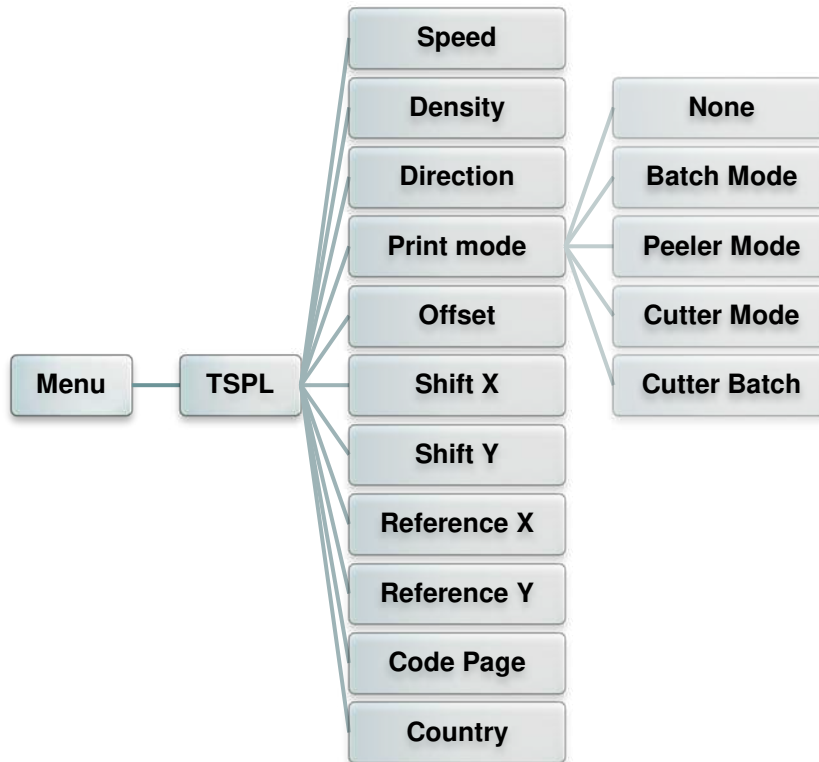

Item	Description	Default						
<b>Speed</b>	Use this item to setup print speed.	5 (203dpi) 3 (300dpi)						
<b>Density</b>	Use this option to setup printing darkness. The available setting is from 0 to 15, and the step is 1. You may need to adjust your density based on selected media.	8						
<b>Direction</b>	<p>The direction setting value is either 1 or 0. Use this item to setup the printout direction.</p>	0						
<b>Print mode</b>	<p>This item is used to set the print mode. There are 5 modes as below,</p> <table border="1"> <thead> <tr> <th>Printer Mode</th> <th>Description</th> </tr> </thead> <tbody> <tr> <td>None</td> <td>Next label top of form is aligned to the print head burn line location. (Tear Off Mode)</td> </tr> <tr> <td>Batch Mode</td> <td>Once image is printed completely, label gap/black mark will be fed to the tear plate location for tear away.</td> </tr> </tbody> </table>	Printer Mode	Description	None	Next label top of form is aligned to the print head burn line location. (Tear Off Mode)	Batch Mode	Once image is printed completely, label gap/black mark will be fed to the tear plate location for tear away.	<b>Batch Mode</b>
Printer Mode	Description							
None	Next label top of form is aligned to the print head burn line location. (Tear Off Mode)							
Batch Mode	Once image is printed completely, label gap/black mark will be fed to the tear plate location for tear away.							



	Peeler Mode	Enable the label peel off mode.	
	Cutter Mode	Enable the label cutter mode.	
	Cutter Batch	Cut the label once at the end of the printing job.	
<b>Offset</b>	This item is used to fine tune media stop location. Available setting value is from “+” to “-” or “0” to “9”.		<b>+000</b>
<b>Shift X</b>	This item is used to fine tune print position. Available setting value is from “+” to “-” or “0” to “9”.		<b>+000</b>
<b>Shift Y</b>			<b>+000</b>
<b>Reference X</b>	This item is used to set the origin of printer coordinate system horizontally and vertically. Available setting value is from “0” to “9”.		<b>000</b>
<b>Reference Y</b>			<b>000</b>
<b>Code page</b>	Use this item to set the code page of international character set.		<b>850</b>
<b>Country</b>	Use this option to set the country code.		<b>001</b>

*Note: If printing from enclosed software/driver, the software/driver will send out the commands, which will overwrite the settings set from the panel.*

## 6.4 ZPL2

This “ZPL2” category can set up the printer settings for ZPL2.

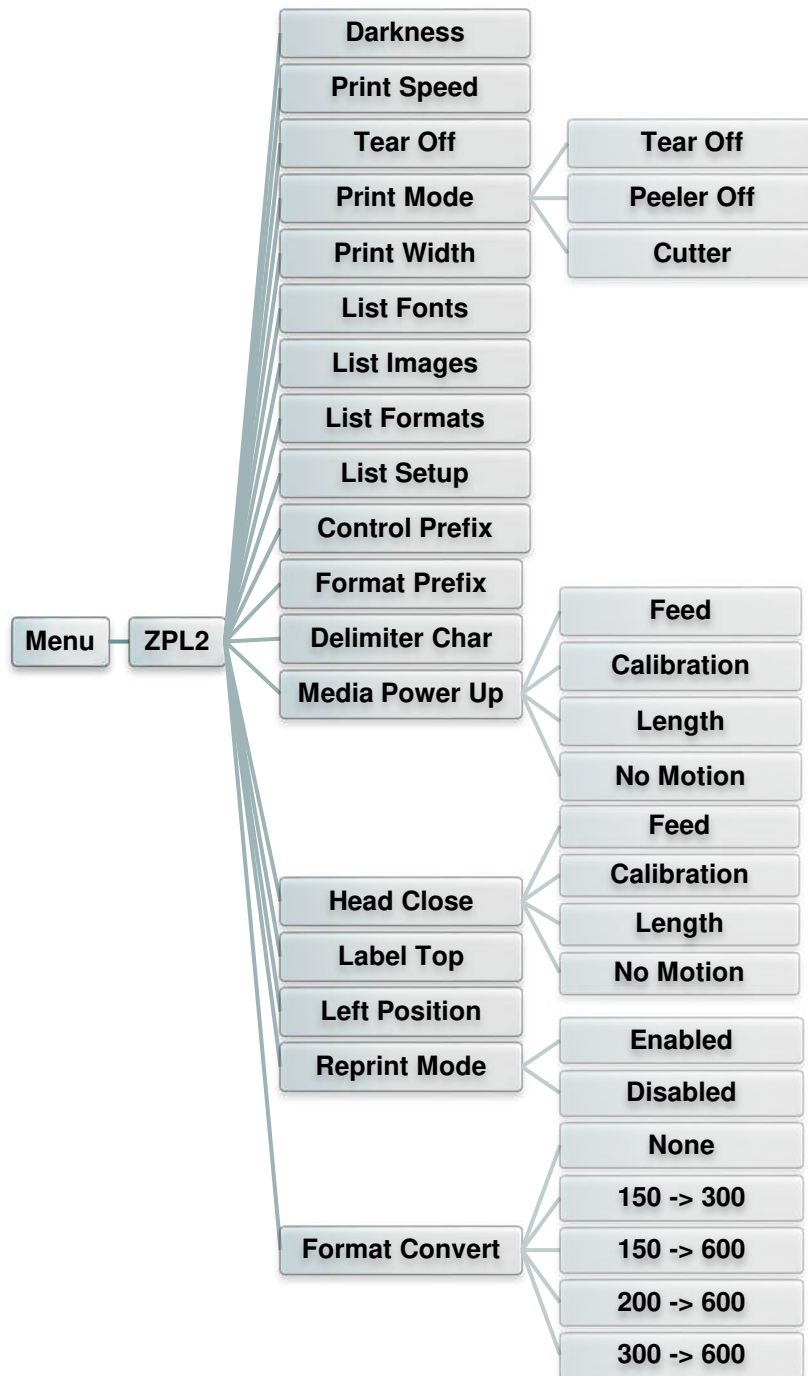

Item	Description	Default
<b>Darkness</b>	Use this item to setup printing darkness. The available setting is from 0 to 30, and the step is 1. You may need to adjust your density based on selected media.	<b>16</b>

<b>Print Speed</b>	Use this item to setup print speed. The each increase or decrease is 1 ips. Available setting is from 2 to 6.	<b>6 (203dpi) 4 (300dpi)</b>										
<b>Tear Off</b>	This item is used to fine tune media stop location. Available setting value is from "+" to "-" or "0" to "9".	<b>+000</b>										
<b>Print mode</b>	<p>This item is used to set the print mode. There are 3 modes as below,</p> <table border="1"> <thead> <tr> <th>Printer Mode</th> <th>Description</th> </tr> </thead> <tbody> <tr> <td>Tear Off</td> <td>Next label top of form is aligned to the print head burn line location.</td> </tr> <tr> <td>Peeler Off</td> <td>Enable the label peel off mode.</td> </tr> <tr> <td>Cutter</td> <td>Enable the label cutter mode</td> </tr> </tbody> </table>	Printer Mode	Description	Tear Off	Next label top of form is aligned to the print head burn line location.	Peeler Off	Enable the label peel off mode.	Cutter	Enable the label cutter mode	<b>Tear Off</b>		
Printer Mode	Description											
Tear Off	Next label top of form is aligned to the print head burn line location.											
Peeler Off	Enable the label peel off mode.											
Cutter	Enable the label cutter mode											
<b>Print Width</b>	This item is used to set print width. The available value is from "0" to "9".	<b>N/A</b>										
<b>List Fonts</b>	This feature is used to print current printer available fonts list to the label. The fonts stored in the printer's DRAM, Flash or optional memory card.	<b>N/A</b>										
<b>List Images</b>	This feature is used to print current printer available images list to the label. The images stored in the printer's DRAM, Flash or optional memory card.	<b>N/A</b>										
<b>List Formats</b>	This feature is used to print current printer available formats list to the label. The formats stored in the printer's DRAM, Flash or optional memory card.	<b>N/A</b>										
<b>List Setup</b>	This feature is used to print current printer configuration to the label.	<b>N/A</b>										
<b>Control Prefix</b>	This feature is used to set control prefix character.	<b>N/A</b>										
<b>Format Prefix</b>	This feature is used to set format prefix character.	<b>N/A</b>										
<b>Delimiter Char</b>	This feature is used to set delimiter character.	<b>N/A</b>										
<b>Media Power Up</b>	<p>This option is used to set the action of the media when you turn on the printer.</p> <table border="1"> <thead> <tr> <th>Selections</th> <th>Description</th> </tr> </thead> <tbody> <tr> <td>Feed</td> <td>Printer will advance one label</td> </tr> <tr> <td>Calibration</td> <td>Printer will calibration the sensor levels, determine length and feed label</td> </tr> <tr> <td>Length</td> <td>Printer determine length and feed label</td> </tr> <tr> <td>No Motion</td> <td>Printer will not move media</td> </tr> </tbody> </table>	Selections	Description	Feed	Printer will advance one label	Calibration	Printer will calibration the sensor levels, determine length and feed label	Length	Printer determine length and feed label	No Motion	Printer will not move media	<b>No Motion</b>
Selections	Description											
Feed	Printer will advance one label											
Calibration	Printer will calibration the sensor levels, determine length and feed label											
Length	Printer determine length and feed label											
No Motion	Printer will not move media											
<b>Head Close</b>	<p>This option is used to set the action of the media when you close the print head.</p> <table border="1"> <thead> <tr> <th>Selections</th> <th>Description</th> </tr> </thead> <tbody> <tr> <td>Feed</td> <td>Printer will advance one label</td> </tr> <tr> <td>Calibration</td> <td>Printer will calibration the sensor levels, determine length and feed label</td> </tr> <tr> <td>Length</td> <td>Printer determine length and feed label</td> </tr> <tr> <td>No Motion</td> <td>Printer will not move media</td> </tr> </tbody> </table>	Selections	Description	Feed	Printer will advance one label	Calibration	Printer will calibration the sensor levels, determine length and feed label	Length	Printer determine length and feed label	No Motion	Printer will not move media	<b>No Motion</b>
Selections	Description											
Feed	Printer will advance one label											
Calibration	Printer will calibration the sensor levels, determine length and feed label											
Length	Printer determine length and feed label											
No Motion	Printer will not move media											
<b>Label Top</b>	This option is used to adjust print position vertically on the label. The range is -120 to +120 dots.	<b>0</b>										
<b>Left Position</b>	This option is used to adjust print position horizontally on the label. The range is -9999 to +9999 dots.	<b>+0000</b>										
<b>Reprint Mode</b>	When reprint mode is enabled, you can reprint the last label printer by	<b>Disabled</b>										

	pressing “UP” button on printer’s control panel.	
<b>Format Convert</b>	Selects the bitmap scaling factor. The first number is the original dots per inch (dpi) value; the second, the dpi to which you would like to scale.	<b>None</b>

*Note: If printing from enclosed software/driver, the software/driver will send out the commands, which will overwrite the settings set from the panel.*

## 6.5 Sensor

This option is used to calibrate the selected sensor. We recommend calibrate the sensor before printing when changing the media.

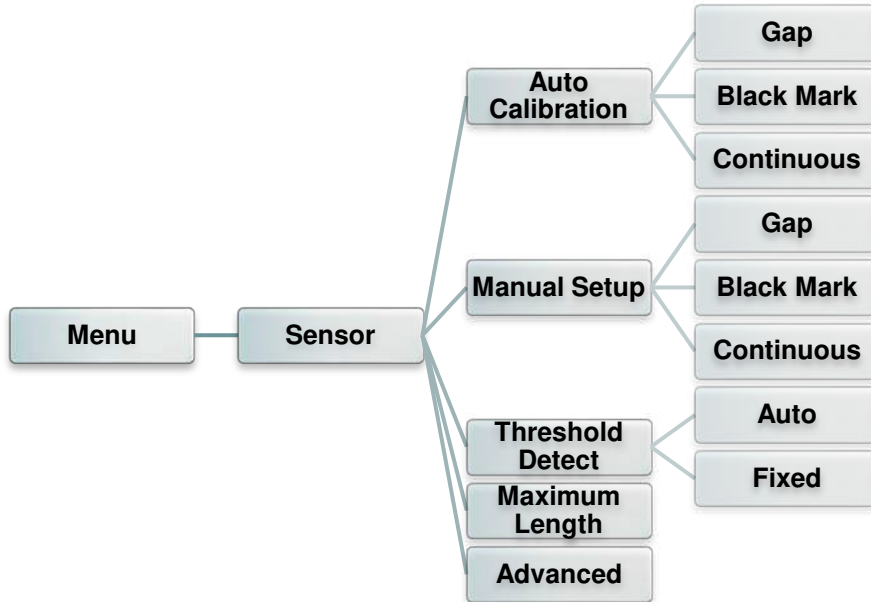

Item	Description	Default
<b>Auto Calibration</b>	Printer will feed 2 to 3 gap labels to calibrate the sensor sensitivity automatically.	<b>N/A</b>
<b>Manual Setup</b>	In case “Auto calibration” cannot apply to the media, please use “Manual setup” function to calibrate the sensor sensitivity.	<b>N/A</b>
<b>Threshold Detect</b>	This option is used to set sensor sensitivity in fixed or auto.	<b>Auto</b>
<b>Maximum Length</b>	This option is used to set the maximum length for label calibration.	<b>254mm</b>
<b>Advanced</b>	This function can set the minimum paper length and maximum gap/bline length for auto-calibrate the sensor sensitivity.	<b>OFF</b>

## 6.6 Interface

This option is used to set the printer interface settings.



### 6.6.1 Serial Comm.

This option is used to set the printer RS-232 settings.

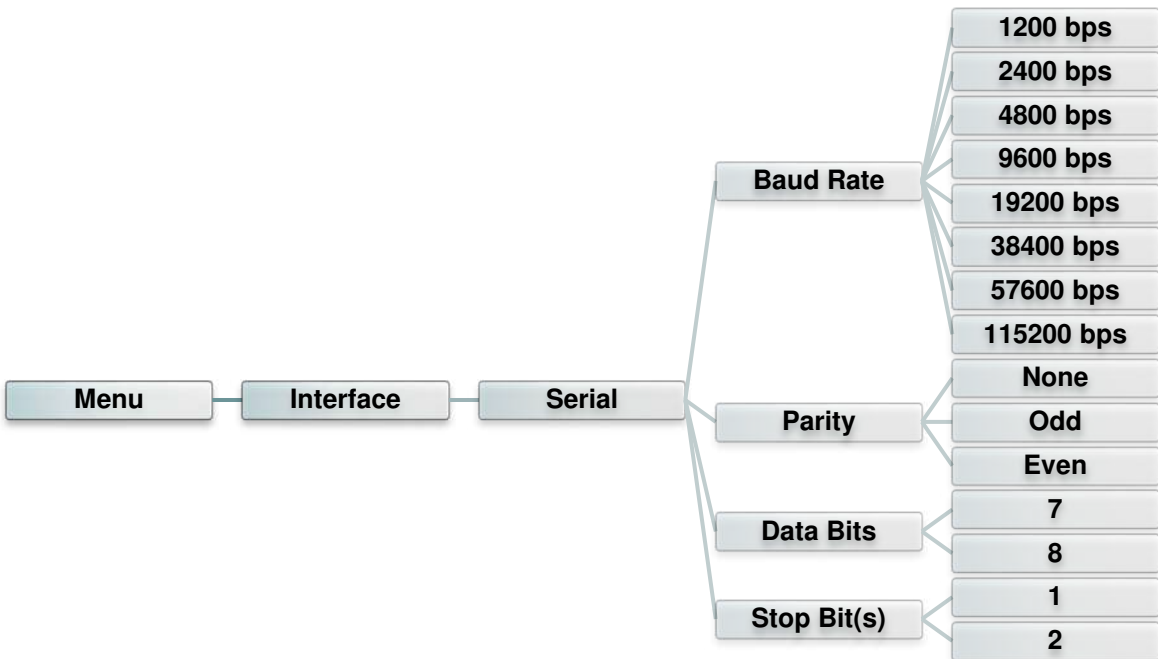

Item	Description	Default
<b>Baud Rate</b>	This item is used to set the RS-232 baud rate.	<b>9600</b>
<b>Parity</b>	This item is used to set the RS-232 parity.	<b>None</b>
<b>Data Bits</b>	This item is used to set the RS-232 Data Bits.	<b>8</b>
<b>Stop Bit(s)</b>	This item is used to set the RS-232 Stop Bits.	<b>1</b>

## 6.6.2 Ethernet

Use this menu to configure internal Ethernet configuration check the printer's Ethernet module status, and reset the Ethernet module.

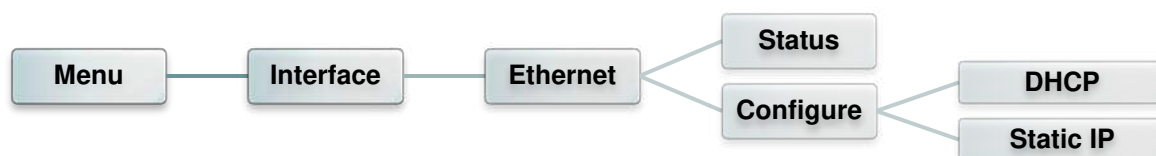

Item	Description	Default
<b>Status</b>	Use this menu to check the Ethernet IP address and MAC setting status.	<b>N/A</b>
<b>DHCP</b>	This item is used to ON or OFF the DHCP (Dynamic Host Configuration Protocol) network protocol.	<b>ON</b>
<b>Static IP</b>	Use this menu to set the printer's IP address, subnet mask and gateway.	<b>N/A</b>

# 6.7 File Manager

This feature is used to check the printer available memory and file list.



Item	Description
<b>DRAM</b>	Use this menu to show, delete and run (.BAS) the files saved in the printer DRAM memory.
<b>FLASH</b>	Use this menu to show, delete and run (.BAS) the files saved in the printer Flash memory.
<b>CARD</b>	Use this menu to show, delete and run (.BAS) the files saved in the printer Card memory.



## 6.8 Diagnostics

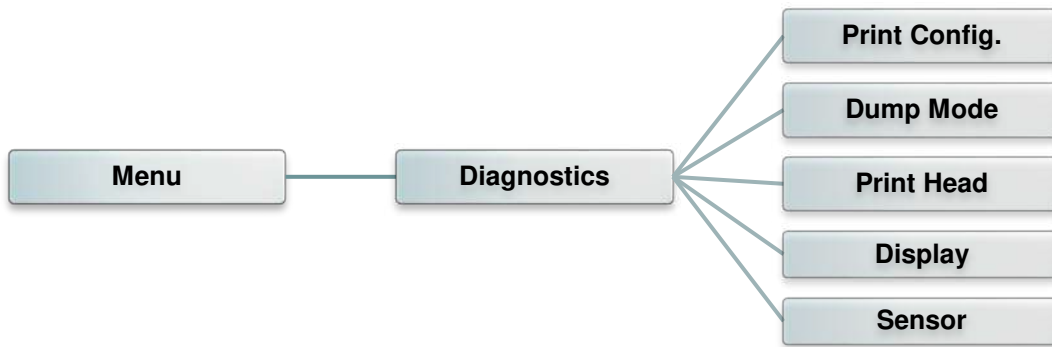

### 6.8.1 Print Config.

This feature is used to print current printer configuration to the label. On the configuration printout, there is a print head test pattern, which is useful for checking if there is any dot damage on the print head heater element.



Self-test printout	
----- SYSTEM INFORMATION -----	
MODEL: XXXXXX	Model name
FIRMWARE: X.XX	F/W version
CHECKSUM: XXXXXXXX	Firmware checksum
S/N: XXXXXXXXXXXX	Printer S/N
TCF: NO	Configuration file
DATE: 1970/01/01	System date
TIME: 00:04:18	System time
NON-RESET: 110 m (TPH)	Printed mileage (meter)
RESET: 110 m (TPH)	
NON-RESET: 0 (CUT)	Cutting counter
RESET: 0 (CUT)	
----- PRINTING SETTING -----	
SPEED: 5 IPS	Print speed (inch/sec)
DENSITY: 8.0	Print darkness
WIDTH: 4.00 INCH	Label size (inch)
HEIGHT: 4.00 INCH	Gap distance (inch)
GAP: 0.00 INCH	Gap/black mark sensor
INTENSION: 5	intension
CODEPAGE: 850	Code page
COUNTRY: 001	Country code
-----	

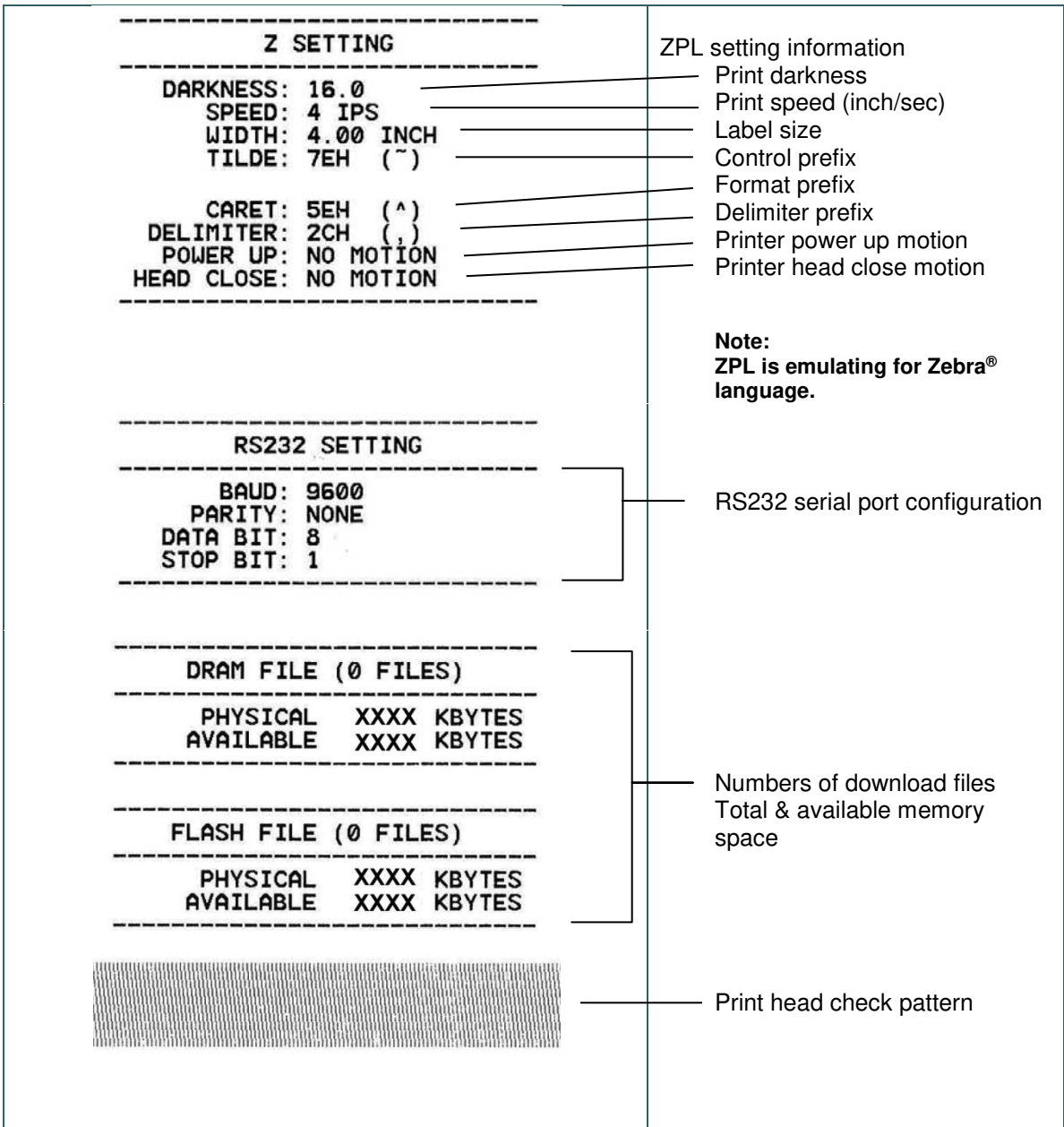

**Note:**  
Checking dot damage requires 4" wide paper width.

## 6.8.2 Dump Mode

Captures the data from the communications port and prints out the data received by printer. In the dump mode, all characters will be printed in 2 columns. The left side characters are received from your system and right side data are the corresponding hexadecimal value of the characters. It allows users or engineers to verify and debug the program.

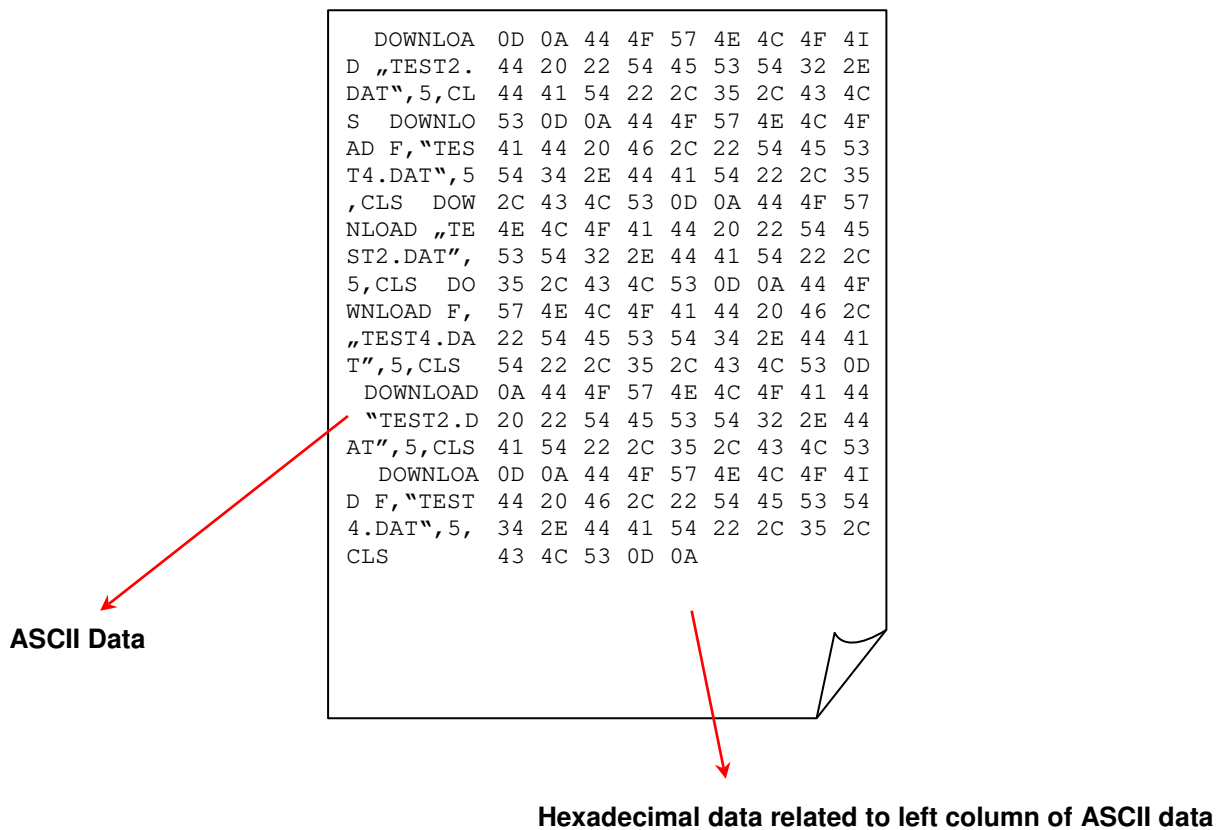

**Note:**  
*Dump mode requires 4" wide paper width.*

### 6.8.3 Print Head

This feature is used to check print head's temperature, resistance and bad dots.

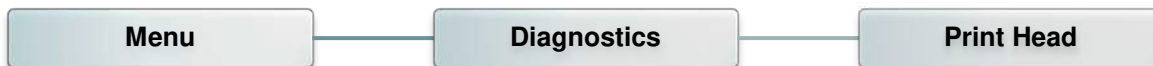

### 6.8.4 Display

This feature is used to check LCD's color state.



### 6.8.5 Sensor

This feature is used to check media sensor state. It can increase or decrease the intensity to check the reading value for diagnostic.

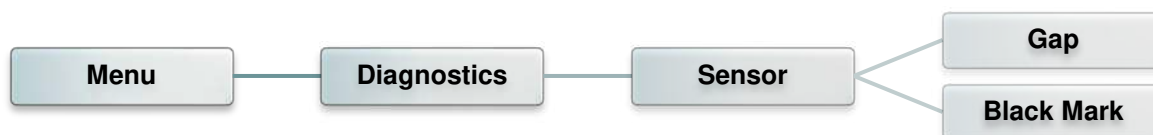

## 6.9 Advanced

This feature is used to set the printer LCD settings.



Item	Description
<b>Display Brightness</b>	This item is used to setup the brightness for display.
<b>Date &amp; Time</b>	This item is used to setup the date and time on display.
<b>Language</b>	This item is used to setup the language on display.

## 6.10 Service

This feature is used to restore printer settings to defaults and checking information for printer.



Item	Description
<b>Initialization</b>	This feature is used to restore printer settings to defaults.
<b>Printer Information</b>	This feature is used to check the printer's serial number, printed mileage (m), printed labels (pcs.) and cutting counter.
<b>Contact Us</b>	This feature is used to check the contact information for tech support service.

## 7. Troubleshooting

The following guide lists the most common problems that may be encountered when operating this bar code printer. If the printer still does not function after all suggested solutions have been invoked, please contact the tech support service of your purchased reseller or distributor for assistance.

Problem	Possible Cause	Recovery Procedure
<b>Power indicator does not illuminate</b>	* The power cord is not properly connected.	* Plug the power cord in printer and outlet. * Switch the printer on.
<b>“Carriage Open”</b> displayed on LCD	* The printer head is open.	* Please close the print carriages.
<b>“No Ribbon”</b> displayed on LCD	* Running out of ribbon. * The ribbon is installed incorrectly.	* Supply a new ribbon roll. * Please refer to the steps on section 3.3 to re-install the ribbon.
<b>“No Paper”</b> displayed on LCD	* Running out of label. * The label is installed incorrectly. * Gap/black mark sensor is not calibrated.	* Supply a new label roll. * Please refer to the steps on section 3.4 to reinstall the label roll. * Calibrate the gap/black mark sensor.
<b>“Paper Jam”</b> displayed on LCD	* Gap/black mark sensor is not set properly. * Make sure label size is set properly. * Labels may be stuck inside the printer mechanism.	* Calibrate the media sensor. * Set media size correctly. * Remove the stuck label inside the printer mechanism.
<b>“Take Label”</b> displayed on LCD	* Peel-off function is enabled.	* If the peel-off module is installed, please remove the label. * If there is no peel-off module in front of the printer, please switch off the printer and install it. * Check if the connector is plugging correctly.
<b>Not Printing</b>	* Check if interface cable is well connected to the interface connector. * The port specified in the Windows driver is not correct. * The Ethernet IP, subnet mask, gateway is not configured properly.	* Re-connect cable to interface or change a new cable. * If using serial cable, - Please replace the cable with pin to pin connected. - Check the baud rate setting. The default baud rate setting of printer is 9600,n,8,1. * If using the Ethernet cable, - Check if the Ethernet RJ-45 connector green LED is lit on. - Check if the Ethernet RJ-45 connector amber LED is blinking. - Check if the printer gets the IP address

		<p>when using DHCP mode.</p> <ul style="list-style-type: none"> <li>- Check if the IP address is correct when using the static IP address.</li> <li>- Wait a few seconds let the printer get the communication with the server then check the IP address setting again.</li> </ul> <p>* Select the correct printer port in the driver.</p> <p>* Check your program if there is a command PRINT at the end of the file and there must have CRLF at the end of each command line.</p>
<b>No print on the label</b>	<ul style="list-style-type: none"> <li>* Label or ribbon is loaded not correctly.</li> <li>* Use wrong type paper or ribbon</li> </ul>	<ul style="list-style-type: none"> <li>* Follow the instructions in loading the media and ribbon.</li> <li>* Ribbon and media are not compatible.</li> <li>* Verify the ribbon-inked side.</li> <li>* The print density setting is incorrect.</li> <li>* Clean the print head.</li> </ul>
<b>Poor Print Quality</b>	<ul style="list-style-type: none"> <li>* Ribbon and media is loaded incorrectly</li> <li>* Dust or adhesive accumulation on the print head.</li> <li>* Print density is not set properly.</li> <li>* Print head element is damaged.</li> <li>* Ribbon and media are incompatible.</li> <li>* The print head pressure is not set properly.</li> </ul>	<ul style="list-style-type: none"> <li>* Reload the supply.</li> <li>* Clean the print head.</li> <li>* Clean the platen roller.</li> <li>* Adjust the print density and print speed.</li> <li>* Run printer self-test and check the print head test pattern if there is dot missing in the pattern.</li> <li>* Change proper ribbon or proper label media.</li> <li>* The release lever does not latch the print head properly.</li> </ul>
<b>Cutter is not working</b>	<ul style="list-style-type: none"> <li>* The connector is loose.</li> <li>* Cutter jam.</li> <li>* Cutter PCB is damaged.</li> </ul>	<ul style="list-style-type: none"> <li>* Plug in the connect cable correctly.</li> <li>* Remove the label.</li> <li>* Make sure the thickness of label is less than 0.19 mm.</li> <li>* Replace a cutter driver IC board.</li> </ul>
<b>Can't downloading the file to memory (FLASH / DRAM/CARD)</b>	<ul style="list-style-type: none"> <li>* Flash/DRAM/CARD memory is full.</li> </ul>	<ul style="list-style-type: none"> <li>* Delete unused files in the memory.</li> </ul>
<b>SD card is unable to use</b>	<ul style="list-style-type: none"> <li>* SD card is damaged.</li> <li>* SD card doesn't insert correctly.</li> </ul>	<ul style="list-style-type: none"> <li>* Use the supported capacity SD card. Please refer to section 2.2.1.</li> <li>* Insert the SD card again.</li> </ul>
<b>Missing printing on the left or right side of label</b>	<ul style="list-style-type: none"> <li>* Wrong label size setup.</li> </ul>	<ul style="list-style-type: none"> <li>* Set the correct label size.</li> </ul>
<b>Gray line on the blank label</b>	<ul style="list-style-type: none"> <li>* The print head is dirty.</li> <li>* The platen roller is dirty.</li> </ul>	<ul style="list-style-type: none"> <li>* Clean the print head.</li> <li>* Clean the platen roller.</li> </ul>
<b>Irregular printing</b>	<ul style="list-style-type: none"> <li>* The printer is in Hex Dump mode.</li> <li>* The RS-232 setting is incorrect.</li> </ul>	<ul style="list-style-type: none"> <li>* Turn off and on the printer to skip the dump mode.</li> <li>* Re-set the Rs-232 setting.</li> </ul>
<b>Label feeding is not stable (skew) when printing</b>	<ul style="list-style-type: none"> <li>* The media guides do not touch the edge of the media.</li> </ul>	<ul style="list-style-type: none"> <li>* Move the label guides to fit the edge of the media. Make sure the label guides touch the edge of the media guide.</li> </ul>

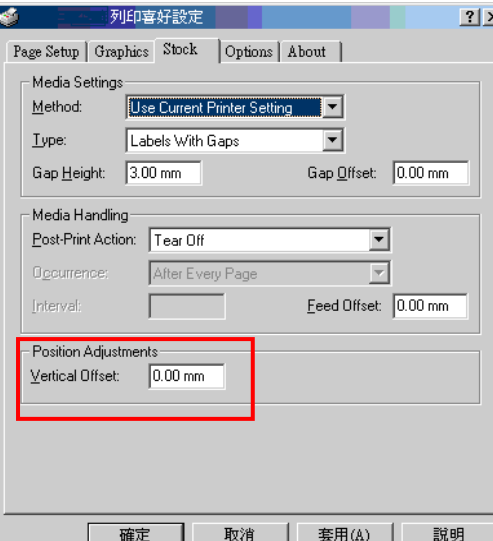

<b>Skip labels when printing</b>	<ul style="list-style-type: none"> <li>* Label size is not set properly.</li> <li>* Sensor sensitivity is not set properly.</li> <li>* The media sensor is dirty.</li> </ul>	<ul style="list-style-type: none"> <li>* Check if label size is setup correctly.</li> <li>* Calibrate the sensor by Auto Gap or Manual Gap options.</li> <li>* Clear the GAP/Black mark sensor by blower.</li> </ul>
<b>Wrinkle Problem</b>	<ul style="list-style-type: none"> <li>* Ribbon installation is incorrect.</li> <li>* Media installation is incorrect.</li> <li>* Print density is incorrect.</li> <li>* Media feeding is incorrect.</li> </ul>	<ul style="list-style-type: none"> <li>* Please set the suitable density to have good print quality.</li> <li>* Make sure the label guides touch the edge of the media guide.</li> </ul>
<b>RTC time is incorrect when reboot the printer</b>	<ul style="list-style-type: none"> <li>* The battery has run down.</li> </ul>	<ul style="list-style-type: none"> <li>* Check if battery is installed on the main board.</li> </ul>
<b>The printing position of small label is incorrect</b>	<ul style="list-style-type: none"> <li>* Media sensor sensitivity is not set properly.</li> <li>* Label size is incorrect.</li> <li>* The parameter Shift Y is incorrect.</li> <li>* The vertical offset setting in the driver is incorrect.</li> </ul>	<ul style="list-style-type: none"> <li>* Calibrate the sensor sensitivity again.</li> <li>* Set the correct label size and gap size.</li> <li>* Use "Configuration Utility" to fine tune the parameter of Shift Y.</li> <li>* If using the software BarTender, please set the vertical offset in the driver.</li> </ul> 

## 8. Maintenance

This session presents the clean tools and methods to maintain your printer.

1. Please use one of following material to clean the printer.

- Cotton swab
- Lint-free cloth
- Vacuum / Blower brush
- 100% Ethanol or Isopropyl Alcohol

2. The cleaning process is described as following,

Printer Part	Method	Interval
<b>Print Head</b>	1. Always turn off the printer before cleaning the print head. 2. Allow the print head to cool down for a minimum of one minute. 3. Use a cotton swab and 100% Ethanol or Isopropyl Alcohol to clean the print head surface.	Clean the print head when changing a new label roll.
<b>Platen Roller</b>	1. Turn the power off. 2. Rotate the platen roller and wipe it thoroughly with water.	Clean the platen roller when changing a new label roll
<b>Peel Bar</b>	Use the lint-free cloth with 100% ethanol to wipe it.	As needed
<b>Sensor</b>	Compressed air or vacuum	Monthly
<b>Exterior</b>	Wipe it with water-dampened cloth	As needed
<b>Interior</b>	Brush or vacuum	As needed

### Note:

- Do not touch printer head by hand. If you touch it careless, please use ethanol to clean it.
- Please use 100% Ethanol or Isopropyl Alcohol. DO NOT use medical alcohol, which may damage the printer head.
- Regularly clean the print head and supply sensors once change a new media to keep printer performance and extend printer life.

- Continuous printing will cause the printer motor to overheat. The printer will stop printing automatically for about 10~15 minutes while the motor is cooling down. Do not turn the power off when the printer pauses or the data transferred to the printer buffer will be lost.
- The maximum printing ratio per dot line is 15% for this printer. To print the full web black line, the maximum black line height is limited to 40 dots, which is 5mm for 203 DPI resolution printer and 3.3mm for 300 DPI resolution printer only, otherwise this may damage the power supply.

# Revision History

---

Date	Revision	Content
2017/5/15	A	Initial Release



