



T4000 Compact Thermal/RFID Printer

Productivity • Adaptability • Dependability

Small, Fast and Ready to Boost Productivity

The T4000 light industrial printer series is our most compact and affordable industrial printer with the ability to print 5,000 labels a day at speeds of up to 12-inches per second. If you are looking to improve productivity – look no further. The T4000 includes RFID capability, Printronix System Architecture (PSA), multiple connectivity options, and remote printer management tools and automated alerts to keep your enterprise operating at optimum efficiency and productivity.

RFID upgrade kits are available for the T4000 standard model to provide customers a cost-effective solution to integrate RFID technology into their operation without the upfront investment.

Product Benefits

- High performance ARM Cortex-A7
- 128MB RAM / 128MB Flash Memory
- Four-inch print width
- Available in 203dpi or 300dpi
- Steel frame enclosure w/ bifold media door
- Supports all major thermal printer languages
- Transfer and direct printing
- Color 3.5in LCD nine-key control panel
- Standard Ethernet, USB, and serial interfaces
- Optional Wi-Fi 802.11a/b/g/n/ac and MFi Bluetooth 5.0
- Enterprise level Ethernet and Wi-Fi security
- Optional RFID Encoder/Antenna System
- 4-32 GB SD memory card capability
- Premium Asian and Andale font support



Enterprise Level Productivity

- Industry-leading print speed of 12 ips
- Easily prints 5,000 labels a day in demanding environments
- Compatible with PrintNet Enterprise, printer management tool
- Fast ARM Cortex A-7 processor
- Automated alerts keep your enterprise efficient and productive
- Uptime is maximised with 450m ribbons and 8" label roll capacity



Adaptable Features

- Extensive standard connectivity: Ethernet, USB Host, USB device, serial
- RFID print/encode for standard smart labels, on-metal tags and many other tag constructions
- Optional connectivity: Enterprise level WiFi 802.11a/b/ g/n/ac, MFi Bluetooth 5.0
- Enterprise level WiFi encryption and security protocols
- Nine printer emulations for seamless integrations
- Compact size makes it a good fit for multiple industries
- Upgrade kits available with tear and cutter (media handling)



Dependable Design

- Rugged metal enclosure with bifold side panel
- Built on Printronix System Architecture (PSA) platform for proven dependability
- Proprietary printhead algorithms deliver high-quality barcodes
- Large LCD colour screen and easy-to-use control panel
- High MTBF of up to 12,000 hrs
- Wide operating temperature range from 0°C to 40°C

TSC

Key Features

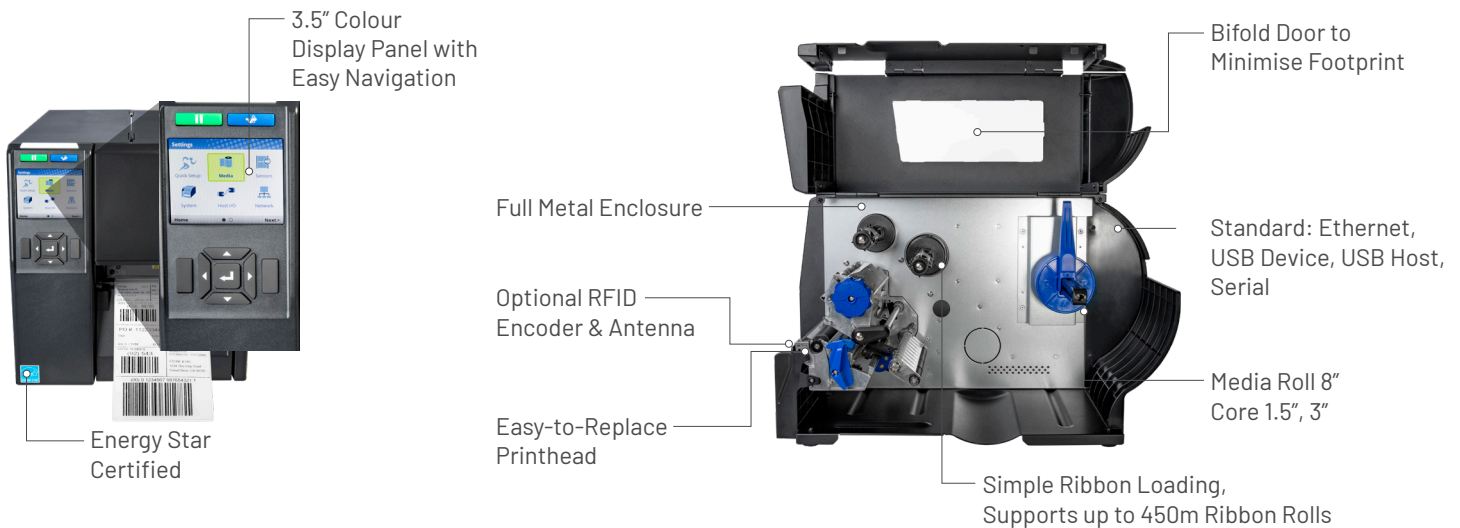

Enterprise Level Productivity

PSA is an intelligent design platform that combines advanced features with a common set of building blocks to simplify printer installation, operation, and improve productivity.

- The printer includes the tools to install, configure and troubleshoot multiple printers at once.
- Printers are fast and reliable for maximum productivity.
- The time required to perform day-to-day tasks has been minimized.
- Includes multiple connectivity options and advanced security protocols.



The T4000 RAIN (GS1 EPC Gen2 v2 / ISO 18000-63) system offers several advanced features.

- Encodes and prints on standard RFID paper labels most commonly used in carton or pallet supply chain applications
- Encodes and prints on-metal tags
- Encodes and prints many other tag constructions such as, Returnable Transport Item tags, Electrostatic Discharge tags, and many more
- Validates encoding process, and automatically overstrikes and reprints any RFID label (or tag) that fails to encode properly
- Records all RFID labels for encoding process, tracks success/failure rates



Ease of Installation

- Drop-in installation with minimal setup & multiple emulations
- Easy to configure control panel or with interactive webpage
- Full suite of connectivity options & security protocols



Ease of Maintenance

- Remotely troubleshoot & monitor printer status
- Push firmware & re-configure printers in batches
- Easy printer swap with quick change memory card (QCMC)
- Commonality of operation between all Printronix Auto ID printers



Reliable Label Production

- Easy to use large colour LCD display with intuitive icon-driven menu
- Fast print speed and time-to-firstprint
- More uptime with easy load media and large ribbon rolls
- Dependable production up to 5,000 labels per day

T4000 | Data Sheet

Model	T4000	
Resolution	203dpi or 300dpi	
Printing method	Direct Thermal and Transfer Thermal	
Max. print speed	12ips @ 203dpi, 10ips @ 300dpi	
Max. print width	4.1" (104mm)	
Media type	Roll or Fan-Fold Labels, Tags, Paper, Film, Tickets	
Media handling	Standard: Continuous, Tear-Off Options: Peel/Rewind (paper labels, 6ips, rewinds liner from 8 in roll) Cutter (thickness as per media spec, life 500,000 cuts) (Does not support on-metal RFID labels/tags)	
Media width	Min 1" (25.4mm) / Max 4.72" (120mm)	
Media thickness	0.002" (0.06mm) to 0.011" (0.279mm) / RFID Max thickness 0.05" (1.2mm)	
Media length	Min.: Continuous, Tear-Off 0.25" (6.35mm) Min.: Peel-Off, Cutter 1.0" (25.4mm) Max.: 50" (1,270mm)	
Media core diameter	1.5" (38.1mm) - 3.0" (76.2mm)	
Media max. roll diameter	8.0" (209mm)	
Ribbon type	Wax, Wax/Resin, Resin	
Ribbon width	Min 1.6" (40mm) / Max 4.33" (110mm)	
Ribbon length	1476.4 ft (450m)	
Ribbon core diameter	1.0" (25.4mm)	
Interface I/O	Standard: Serial RS232, USB, and Ethernet 10/100Base T / Optional: Wi-Fi 802.11a/b/g/n/ac, MFi Bluetooth 5.0	
WiFi security encryption	WEP 40/128bit, WPA Personal (PSK), WPA2 Personal (PSK), Enterprise (AES CCMP)	
WiFi security authentication	EAP-TLS, EAP-TTLS, PEAPv0/MS-CHAPv2, PEAPv1, EAP-MDS, LEAP	
Remote management software	PrintNet Enterprise Suite, SOTI Connect: IoT device management	
Memory	128 MB Flash / 128 MB DDR	
Line input	Auto Range 100 - 240 VAC (48 - 62 Hz)	
Fonts	Font Technologies: Intellifont, TrueType, Unicode Standard Fonts: OCRA, OCRB, Courier, Letter Gothic, CG Times, CG Triumvirate/Bold/Condensed Premium Asian Fonts (Optional SD card): Simplified Chinese, Japanese, Korean, Thai Andale Asian Fonts (Optional SD card): Simplified Chinese, Traditional Chinese, Korean, Japanese PDF/ PostScript Level 3: 35 fonts	
Graphic formats	PCX, TIFF, BMP, PNG	
Barcode	1D barcode: BC-412, Code 11, Code 39, Code 35, Code 93, Codabar, Code128 Subsets A/B/C, Industrial 2 of 5, Interleave 2 of 5, German I-2/5, EAN-8, EAN-13, UCC/EAN-128, UPC-A, UPC-E, UPCSHP, UPS 11, MSI, Matrix 2 of 5, PLESSEY, POSTNET, 4-state PostBar, Australian 4-state, FIM, ITF14, TELEPEN, PLANET, USPS Intelligent Mail, LOGMARS 2D barcode: PDF-417, MicroPDF-417, Maxicode, DataMatrix, QR Codes, Aztec, GS1 Databar (RSS-14)	
RFID	RAIN UHF Passive (GS1 EPC Gen2 v2 / ISO 18000-63) Fixed Position Antenna Standard/On-Metal Tags/ Additional Tag Constructions Minimum Label/Tag Pitch 0.625" (15.9 mm)	On-Metal Tag Thickness up to 0.05" (1.2mm) Printer languages: PGL, ZGL, STGL, MGL Counters: Tracks good/overstruck labels/tags
Operating environment	Operating Temperature: 32° to 104°F (0° to 40°C) (limitations based on selected media) / Operating Humidity: 25-85% Non-Condensing Storage Temperature: -40° to 140° F (-40° to 60° C) / Storage Humidity: 10 - 90% Non-Condensing	
Regulatory compliances	Emissions: FCC, CE, IC, CCC, KC Safety: cTUVus, CE, IC, EAC, SMARK, NOM, CCC, KC, BIS, BSMI Environmental: RoHS, WEEE, Energy Star 3.0 RFID: FCC, CE, ANATEL, ICT, KC, MIC, NCC., SRRC, WPC WiFi/BT: US, Canada, European Union, China	
Physical dimension (W x H x D)	10.40" (264mm) x 10.9" (276mm) x 17.9" (455mm)	
Weight	22lbs (10kg)	
Options & Accessories	Wi-Fi 802.11a/b/g/n/ac MFi Bluetooth 5.0 Cutter Peel/Rewind	Andale Asian Font Card Premium Asian Font Card OCMC (Quick Change Memory Card) RFID Encoder/Antenna System



Global Headquarters

9F, No. 95, Minquan Road, Xindian District
New Taipei City, Taiwan 231
Office: +886 2 2218 6789

EMEA

Georg-Wimmer-Ring 8b
85604 Zorneding, Germany
Office: +49 8106 37979 000

Americas

3040 Saturn Street, Suite 200
Brea, CA 92821 U.S.A.
Office: +1 657 258 0808